

- NOTES:
- 1. CONTRACTOR SHALL INSTALL STOP BARS AND YIELD MARKINGS IN EACH DIRECTION (4).
 - 2. ALL MARKINGS FROM TRAFFIC CHANNELIZATION FOR MEDIAN STRIPING SHALL BE THERMOPLASTIC, CLASS 2, TYPE A.
 - 3. CONTRACTOR SHALL CLIP AND SWEEP SHOULDERS PRIOR TO PAVING OPERATIONS; THE CONTRACTOR SHALL REMOVE OR WINDROW EXCESS MATERIALS AND EVENLY SPREAD TO PROVIDE SHOULDER BEDDING FOR STRIP SOD (PAY ITEMS 212-A AND 654-A).
 - 4. SPRAY ALL GRASS GROWING IN PAVEMENT CRACKS.
 - 5. PUBLIC WORKS DEPARTMENT WILL RESET STOP / YIELD SIGNS AS REQUIRED.

REMOVE
NOTE 5.

ALTERNATE NO. 1

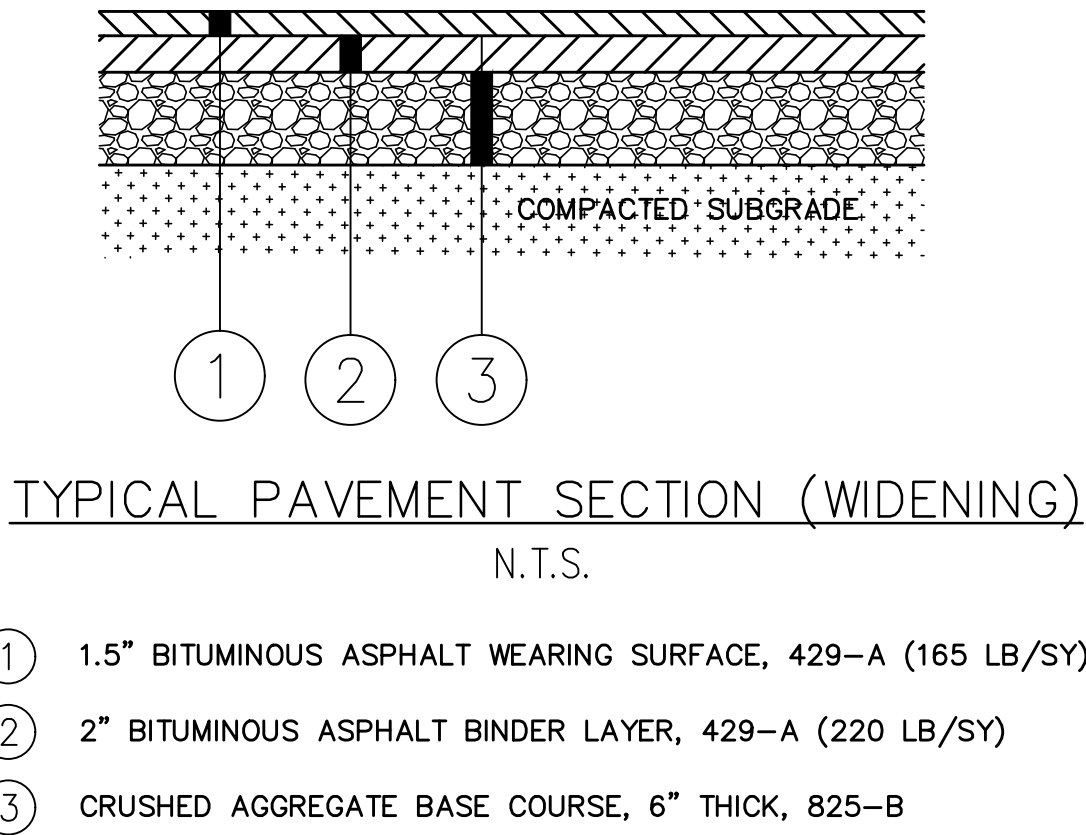

STREET DATA:
ASPHALT = 1,733 S.Y.

NUMBER:	REVISION:	DATE:	<div><p>ENGINEERING - SURVEYING - CONSTRUCTION MANAGEMENT</p><p>11143 Old Highway 31 Spanish Fort, AL 36527 Phone: (251) 544-7900</p></div>	PRIDE DR. & PINE ST. INTERSECTION		SCALE: 1"=20'
				RESURFACING PROJECT - 2019		DATE: MAY, 2019
				CITY OF FOLEY		DRAWN BY: JC
						CHECKED BY: SJD
						SHEET: 14A OF 14

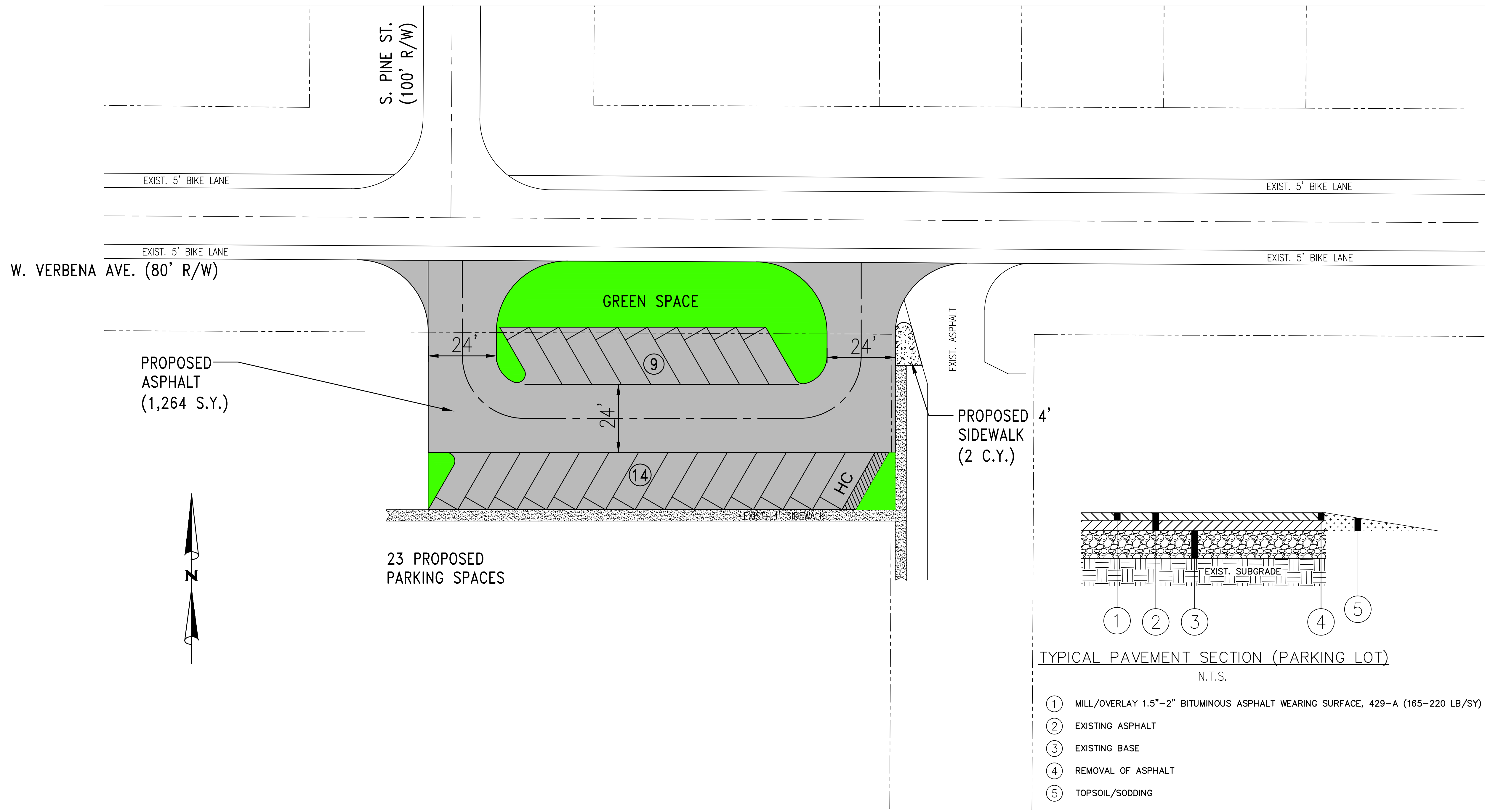

- NOTES:
1. ALL SPACES SHALL HAVE CONCRETE PARKING BUMPERS, SET IN PLACE.
 2. CONTRACTOR SHALL INSTALL STOP BARS AT EACH INTERSECTION THAT HAS A STOP SIGN AND STOP CONDITION. ALL STOP BARS AND CROSSWALKS SHALL BE THERMOPLASTIC, CLASS 2, TYPE A.
 3. PARKING STALLS AND H/C SPACES SHALL BE STRIPED W/ 4", CLASS 1H, TYPE A (HIGH BUILD PAINT)
 4. CONTRACTOR SHALL CLIP AND SWEEP SHOULDERS PRIOR TO PAVING OPERATIONS; THE CONTRACTOR SHALL REMOVE OR WINDROW EXCESS MATERIALS AND EVENLY SPREAD TO PROVIDE SHOULDER BEDDING FOR STRIP SOD (PAY ITEMS 212-A AND 654-A).
 5. SPRAY ALL GRASS GROWING IN PAVEMENT CRACKS.

ALTERNATE NO. 2

STREET DATA:
ASPHALT = 1,264 S.Y.

NUMBER:	REVISION:	DATE:	 <p>ENGINEERING - SURVEYING - CONSTRUCTION MANAGEMENT</p> <p>11143 Old Highway 31 Spanish Fort, AL 36527 Phone: (251) 544-7900</p>	VERBENA AVE. - POOL PARKING LOT		SCALE: 1"=20'
				RESURFACING PROJECT - 2019		DATE: MAY, 2019
				CITY OF FOLEY		DRAWN BY: JC
						CHECKED BY: SJD
						SHEET: 14B OF 14