

ACT #2019- 363

1 HB483
2 197072-3
3 By Representatives McMillan, Shiver, Simpson, Faust and Baker
4 (N & P)
5 RFD: Baldwin County Legislation
6 First Read: 23-APR-19



1
2
3
4
5
6
7
8
9
10
11
12
13
14
15
16
17
18
19
20
21
22
23
24
25

ENROLLED, An Act,
To alter, rearrange, and extend the boundary lines
and corporate limits of the City of Foley in Baldwin County.
BE IT ENACTED BY THE LEGISLATURE OF ALABAMA:

Section 1. The boundary lines and corporate limits
of the City of Foley in Baldwin County are altered,
rearranged, and extended to include within the corporate
limits of the municipality, in addition to the lands now
included, all of the following territory:

Tract 1:

As recorded in Instrument No. 1527413 in the records
of the office of Judge of Probate Court of Baldwin County,
Alabama:

From the Northeast corner of the Northwest Quarter
of the Southeast Quarter of Section 27, Township 7 South,
Range 4 East, run West 25 feet to a point; thence run South 00
degrees 28 minutes East 40 feet; run thence South 00 degrees
28 minutes East 632 feet to a point; thence run Westerly 444
feet, more or less, to a point; thence run Northerly 178 feet,
more or less, to a point; thence run Easterly 444 feet, more
or less, to a point; thence run Northerly 454 feet, more or
less, to the Point of Beginning. (Pin 360902 Wolf Creek Park
LLC)

Tract 2:

1 As recorded in Instrument No. 1278167 in the records
2 of the office of Judge of Probate Court of Baldwin County,
3 Alabama:

4 Commencing at the Northeast corner of Section 27,
5 Township 7 South, Range 4 East, Baldwin County, Alabama, run
6 South 00 degrees 06 minutes 14 seconds East, along the East
7 line of said Section 27, a distance of 2,708.05 feet to a
8 point on the south right-of-way line of US Highway 98; run
9 thence West, along said right-of-way line, a distance of
10 708.20 feet to an iron rebar found; run thence South 00
11 degrees 08 minutes 36 seconds East a distance of 752.29 feet
12 to an iron rebar with plastic cap set by F. William Raber and
13 the Point of Beginning of the property herein described;
14 continue thence South 00 degrees 08 minutes 36 seconds East a
15 distance of 627.79 feet to an iron rebar with plastic cap set
16 by F. William Raber; run thence West a distance of 630.10 feet
17 to an iron rebar with plastic cap set by F. William Raber on
18 the east right-of-way line of Bender Lane; run thence North 00
19 degrees 09 minutes 24 seconds West, along said east
20 right-of-way line of Bender Lane, a distance of 628.38 feet to
21 an iron rebar with plastic cap set by F. William Raber; run
22 thence South 89 degrees 56 minutes 45 seconds East a distance
23 of 630.23 feet to the Point of Beginning; said property
24 containing 9.086 acres. (Pin 341074 Cox)

25 Tract 3:

1 As recorded in Instrument No. 1141169 in the records
2 of the office of Judge of Probate Court of Baldwin County,
3 Alabama:

4 Commence at an iron pin marker at the Northeast
5 corner of Section 27, Township 7 South, Range 4 East, and run
6 thence South 00 degrees 06 minutes 14 seconds East, a distance
7 of 2,668 feet to a point on the centerline of the pavement of
8 US Highway 98, thence continue South 00 degrees 06 minutes 14
9 seconds East, 369.5 feet for a Point of Beginning; thence
10 continue South 00 degrees 06 minutes 14 seconds East, 144.0
11 feet; thence run West, 435.5 feet to an iron pin marker;
12 thence run North 00 degrees 06 minutes 14 seconds West, 144.0
13 feet to an iron pin marker; thence run East 435.5 feet to the
14 Point of Beginning. Tract lies in the Southeast 1/4 of Section
15 27, Township 7 South, Range 4 East, Baldwin County, Alabama.
16 (Pin 90344 Engel)

17 Tract 4:

18 As recorded in Instrument No. 1141169 in the records
19 of the office of Judge of Probate Court of Baldwin County,
20 Alabama:

21 Commence at an iron pin marker at the Northeast
22 corner of Section 27, Township 7 South, Range 4 East, and run
23 thence South 00 degrees 06 minutes 14 seconds East, a distance
24 of 2,668 feet to a point on the centerline of the pavement of
25 US Highway 98, thence continue South 00 degrees 06 minutes 14

1 seconds East, 513.5 feet for a Point of Beginning; thence
2 continue South 00 degrees 06 minutes 14 seconds East, 212.23
3 feet; thence run West, 435.5 feet to an iron pin marker;
4 thence run North 00 degrees 06 minutes 14 seconds West, 212.23
5 feet to an iron pin marker; thence run East 435.5 feet to the
6 Point of Beginning. (Pin 100112 Engel)

7 Tract 5:

8 As recorded in Instrument No. 582416 in the records
9 of the office of Judge of Probate Court of Baldwin County,
10 Alabama:

11 Commencing at the Northeast corner of Section 27,
12 Township 7 South, Range 4 East, run South 00 degrees 06
13 minutes 14 seconds East 3,393.78 feet to the Point of
14 Beginning; continue thence South 00 degrees 06 minutes 14
15 seconds East 609.21 feet; thence run South 89 degrees 53
16 minutes 46 seconds West, 435.5 feet; thence run North 00
17 degrees 06 minutes 14 seconds West 610.0 feet; thence run East
18 435.5 feet to the Point of Beginning. (Pin 107924 Sessions)

19 Tract 6:

20 As recorded in Real Property Book 110 Page 175 in
21 the records of the office of Judge of Probate Court of Baldwin
22 County, Alabama:

23 Starting at the Northeast corner of the Southeast
24 Quarter of the Southeast Quarter of Section 27, Township 7
25 South, Range 4 East, run thence due West 660 feet to a stake;

1 run thence due South 300 feet to a stake; run thence due East
2 660 feet to a stake; run thence due North 300 feet to a stake,
3 being in the Point of Beginning, all lying in Baldwin County,
4 Alabama. (Pin 24920 Lane)

5 Tract 7:

6 As recorded in Instrument No. 890052 in the records
7 of the office of Judge of Probate Court of Baldwin County,
8 Alabama:

9 Commencing at the Northeast corner of the Northeast
10 Quarter of the Southwest Quarter of Section 26, Township 7
11 South, Range 4 East, Baldwin County, Alabama; thence run South
12 00 degrees 19 minutes East a distance of 200.0 feet; run
13 thence North 89 degrees 50 minutes 40 seconds West a distance
14 of 30.0 feet to the West line of Barin Field Road and the
15 Point of Beginning of the property herein described; run
16 thence South 00 degrees 19 minutes East along said West line a
17 distance of 100.0 feet; run thence North 89 degrees 50 minutes
18 40 seconds West a distance of 170.0 feet; run thence North 00
19 degrees 19 minutes West a distance of 100.0 feet; run thence
20 South 89 degrees 50 minutes 40 seconds East a distance of 170
21 feet to the Point of Beginning. (Pin 56715 Thornton)

22 Tract 8:

23 As recorded in Instrument No. 877681 in the records
24 of the office of Judge of Probate Court of Baldwin County,
25 Alabama:

1 Lot 1, Unit 2, Schlicking Subdivision, according to
2 map or plat thereof recorded in the Office of the Judge of
3 Probate of Baldwin County, Alabama, on slide 1380-A. (Pin
4 113200 BJ Residential Properties, LLC)

5 Tract 9:

6 As recorded in Instrument No. 1511296 in the records
7 of the office of Judge of Probate Court of Baldwin County,
8 Alabama:

9 Lot 2, Unit 2, Schlicking Subdivision, according to
10 map or plat thereof recorded in the Office of the Judge of
11 Probate of Baldwin County, Alabama, on slide 1380-A. (Pin
12 113201 McDuffie)

13 Tract 10:

14 As recorded in Instrument No. 1327411 in the records
15 of the office of Judge of Probate Court of Baldwin County,
16 Alabama:

17 Lot 3, Unit 2, Schlicking Subdivision, according to
18 map or plat thereof recorded in the Office of the Judge of
19 Probate of Baldwin County, Alabama, on slide 1380-A. (Pin
20 113202 Buchanan)

21 Tract 11:

22 As recorded in Instrument No. 1216947 in the records
23 of the office of Judge of Probate Court of Baldwin County,
24 Alabama:

1 Lot 4, Unit 2, Schlicking Subdivision, according to
2 map or plat thereof recorded in the Office of the Judge of
3 Probate of Baldwin County, Alabama, on slide 1380-A. (Pin
4 113203 Buchanan)

5 Tract 12:

6 As recorded in Instrument No. 983850 in the records
7 of the office of Judge of Probate Court of Baldwin County,
8 Alabama:

9 Lot 5, Unit 2, Schlicking Subdivision, according to
10 map or plat thereof recorded in the Office of the Judge of
11 Probate of Baldwin County, Alabama, on slide 1380-A. (Pin
12 113204 Thompson)

13 Tract 13:

14 As recorded in Instrument No. 1553561 in the records
15 of the office of Judge of Probate Court of Baldwin County,
16 Alabama:

17 Lot 6, Unit 2, Schlicking Subdivision, according to
18 map or plat thereof recorded in the Office of the Judge of
19 Probate of Baldwin County, Alabama, on slide 1380-A. (Pin
20 113205 Thornton)

21 Tract 14:

22 As recorded in Instrument No. 1580329 in the records
23 of the office of Judge of Probate Court of Baldwin County,
24 Alabama:

1 Commencing at the center of the intersection of
2 Baldwin County Highway No. 20 and James Road at or near the
3 Northeast corner of Section 9, Township 8 South, Range 4 East,
4 run thence in a Westerly direction along the centerline of
5 Baldwin County Highway No. 20, 1388 feet, more or less, to the
6 centerline of a private road providing access to said
7 property; run thence in a Southerly direction along the
8 centerline of said private road 236 feet to a point; run
9 thence in an Easterly direction parallel to the centerline of
10 Baldwin County Highway No. 20, 97.5 feet to a point; run
11 thence in a Northerly direction and parallel to the centerline
12 of the above described private road 236 feet, more or less, to
13 the centerline of Baldwin County Highway No. 20, run thence in
14 a Westerly direction along the centerline of Baldwin County
15 Highway No. 20, 97.5 feet, more or less, to the Point of
16 Beginning. (Pin 367206 Little)

17 Tract 15:

18 As recorded in Instrument No. 1413557 in the records
19 of the office of Judge of Probate Court of Baldwin County,
20 Alabama:

21 Lot 1A of Griffiths Subdivision, according to the
22 map or plat thereof recorded on Slide 2236-C, in the Office of
23 Judge of Probate of Baldwin County, Alabama. (Pin 269838 Ung)

24 Tract 16:

1 As recorded in Instrument No. 1413557 in the records
2 of the office of Judge of Probate Court of Baldwin County,
3 Alabama:

4 Lot 1B of Griffiths Subdivision, according to the
5 map or plat thereof recorded on Slide 2236-C, in the Office of
6 Judge of Probate of Baldwin County, Alabama. (Pin 276651 Ung)

7 Tract 17:

8 As part of the 160 acres, more or less, as recorded
9 in Instrument No. 1255317 in the records of the office of
10 Judge of Probate Court of Baldwin County, Alabama:

11 Being 53 acres, more or less, part of Lot 1
12 Griffith's Subdivision slide 2236-C, being described as
13 commencing at the Northeast corner of Section 9, Township 8
14 South, Range 4 East; thence run South 60 feet, more or less;
15 thence run West 50 feet, more or less; thence run Southerly 40
16 feet, more or less; thence run Southerly 494 feet, more or
17 less to the Point of Beginning; thence run Westerly 250 feet,
18 more or less; thence run Northerly 522.7 feet, more or less;
19 thence run Westerly 99 feet, more or less; thence run
20 Southerly 210 feet, more or less; thence run Westerly 210
21 feet, more or less; thence run Northerly 210 feet, more or
22 less; thence run Westerly 689 feet, more or less; thence run
23 Southerly 176 feet, more or less; thence run Westerly 97.5
24 feet, more or less; thence run Northerly 176 feet, more or
25 less; thence run Westerly 611 feet, more or less; thence run

1 Southerly 1,288 feet, more or less; thence run Easterly 521
2 feet, more or less; thence run Southerly 150 feet, more or
3 less; thence run Easterly 225 feet, more or less; thence run
4 Northerly 150 feet, more or less; thence run Easterly 1,225
5 feet, more or less; thence run Northerly 748 feet, more or
6 less to the Point of Beginning. (Pin 26102 Little)

7 Tract 18:

8 As recorded in Instrument No. 952331 in the records
9 of the office of Judge of Probate Court of Baldwin County,
10 Alabama:

11 Commencing at the Northeast corner of Section 9,
12 Township 8 South, Range 4 East, run South 00 degrees 00
13 minutes 00 seconds East, along the East line of said Section
14 9, 1320.56 feet to the Point of Beginning; continue thence
15 South 00 degrees 00 minutes 00 seconds East along said East
16 line 1320.50 feet; thence run North 89 degrees 55 minutes 50
17 seconds West, 2679.00 feet; thence run North 00 degrees 00
18 minutes 01 seconds West, 1320.73 feet; thence run South 89
19 degrees 55 minutes 10 seconds East, 1184 feet; thence run
20 South 00 degrees 00 minutes 00 seconds East, 154.00 feet;
21 thence run South 89 degrees 55 minutes 50 seconds East, 224.00
22 feet; thence run North 00 degrees 00 minutes 00 seconds West,
23 154.00 feet; thence run South 89 degrees 55 minutes 50 seconds
24 East 1271.00 feet to the Point of Beginning. All being 80.42
25 acres, more or less, and lying in Section 9, Township 8 South,

1 Range 4 East, Baldwin County, Alabama. Less and except any
2 portion lying in a public road right-of-way. (Pin 119541
3 Horne)

4 Tract 19:

5 As recorded in Real Property Book 304 Page 1057 in
6 the records of the office of Judge of Probate Court of Baldwin
7 County, Alabama:

8 The North 527.40 feet of the East 665.00 feet of the
9 Southeast Quarter of Section 9, Township 8 South, Range 4 East
10 less the East 20.00 feet for road right-of-way, containing
11 8.00 acres, more or less, Baldwin County, Alabama. (Pin 72355
12 Beane)

13 Tract 20:

14 As recorded in Instrument No. 1487187 in the records
15 of the office of Judge of Probate Court of Baldwin County,
16 Alabama:

17 Commencing at the Northeast corner of the Southeast
18 Quarter of Section 9, Township 8 South, Range 4 East, Baldwin
19 County, Alabama; thence run South 00 degrees 01 minutes 12
20 seconds West a distance of 1054.80' to a point; thence run
21 South 89 degrees 55 minutes 22 seconds West a distance of
22 20.00' to a point on the west right-of-way line of James Road;
23 thence continue South 89 degrees 55 minutes 22 seconds West a
24 distance of 645.00' to a point; thence run South 00 degrees 01
25 minutes 12 seconds West a distance of 527.40' to a point;

1 thence run North 89 degrees 55 minutes 22 seconds East a
2 distance of 646.00' to a point; thence run North 00 degrees 01
3 minutes 12 seconds East a distance of 527.40' to the Point of
4 Beginning. (Pin 90230 Graham)

5 Tract 21:

6 As recorded in Real Property Book 304 Page 1059 in
7 the records of the office of Judge of Probate Court of Baldwin
8 County, Alabama:

9 The South 527.40 feet of the North 2109.60 feet of
10 the East 665.00 feet of the Southeast Quarter of Section 9,
11 Township 8 South, Range 4 East, less the East 20.00 feet for
12 road right-of-way containing 8.00 acres, more or less, Baldwin
13 County, Alabama. (Pin 91565 Young)

14 Tract 22:

15 As recorded in Instrument No. 899754 in the records
16 of the office of Judge of Probate Court of Baldwin County,
17 Alabama:

18 Being a parcel of land lying in the Northwest
19 Quarter of Section 10, Township 8 South, Range 4 East, Baldwin
20 County, Alabama; Being more particularly described as follows:
21 Commencing at the purported Northwest corner of the Northwest
22 Quarter of said Section 10; thence North 89 degrees 43 minutes
23 50 seconds East, 761.00 feet; thence South 00 degrees 16
24 minutes 10 seconds West, 40.00 feet to a inch crimp top iron
25 pipe found on the south right-of-way of Baldwin County Road

1 No. 20, same being the Point of Beginning of the parcel herein
2 described; thence continuing South 00 degrees 16 minutes 10
3 seconds East, 247.83 feet to a capped iron stamped Parkway
4 found for corner; thence North 89 degrees 43 minutes 50
5 seconds East, 270.17 feet to a capped iron stamped Parkway
6 found for corner; thence North 00 degrees 16 minutes 10
7 seconds West, 77.83 feet to a capped iron stamped 18393 found
8 for corner; thence South 89 degrees 44 minutes 02 seconds
9 West, 117.71 feet to a capped iron stamped PLS #17836 set for
10 corner; thence North 00 degrees 48 minutes 14 seconds West,
11 171.16 feet to a capped iron, not legible, found for corner on
12 said south right-of-way; thence North 89 degrees 17 minutes 30
13 seconds West, along said south right-of-way, 150.88 feet to
14 the Point of Beginning. (Pin 114883 Bennett)

15 Tract 23:

16 As recorded in Instrument No.896756 in the records
17 of the office of Judge of Probate Court of Baldwin County,
18 Alabama:

19 Commencing at the Northwest corner of Section 10,
20 Township 8 South, Range 4 East, Baldwin County, Alabama,
21 thence North 89 degrees 43 minutes 50 seconds East, 911.96
22 feet to a point; thence South 00 degrees 16 minutes 10 seconds
23 East for 40.00 feet to an iron pin on the South right-of-way
24 of County Road No. 20 (80' right-of-way) and Point of
25 Beginning: thence South 00 degrees 49 minutes 17 seconds East

1 for 169.83 feet to an iron pin; thence North 89 degrees 38
2 minutes 21 seconds East for 117.64 feet to an iron pin; thence
3 North 00 degrees 16 minutes 10 seconds West for 169.69 feet to
4 an iron pin; thence South 89 degrees 42 minutes 46 seconds
5 West for 119.27 feet to an iron pin and the Point of
6 Beginning. (Pin 234029 Champion RE LLC)

7 Tract 24:

8 As recorded in Real Property Book 552 Page 1918 in
9 the records of the office of Judge of Probate Court of Baldwin
10 County, Alabama:

11 Commencing at the Northwest corner of Section 10,
12 Township 8 South, Range 4 East, Baldwin County, Alabama;
13 thence South 00 degrees 02 minutes 57 seconds East for 1177.55
14 feet; thence North 89 degrees 57 minutes 03 seconds East for
15 20.0 feet to the East right-of-way line of a 40 foot dirt road
16 and the Point of Beginning; thence continue North 89 degrees
17 57 minutes 03 seconds East for 295.42 feet to an iron rod and
18 cap #18393; thence North 00 degrees 02 minutes 57 seconds West
19 for 141.42 feet to an iron rod and cap #18393; thence South 89
20 degrees 57 minutes 03 seconds West 295.42 feet, thence South
21 00 degrees 02 minutes 57 seconds East for 141.42 feet to the
22 Point of Beginning. (Pins 51706 & 119542 James)

23 Tract 25:

1 As recorded in Instrument No. 928513 in the records
2 of the office of Judge of Probate Court of Baldwin County,
3 Alabama:

4 Commencing at the Northwest corner of Section 18,
5 Township 8 South, Range 5 East, thence run South 00 degrees 12
6 minutes 34 seconds East, 107.51 feet to an iron pin; thence
7 run South 00 degrees 25 minutes 13 seconds West, 259.96 feet
8 to an iron pin and the Point of Beginning; thence run South 89
9 degrees 55 minutes 19 seconds East, 474.64 feet to an iron
10 pin; thence run South 41 degrees 53 minutes 53 seconds East,
11 184.43 feet to an iron pin; thence run South 06 degrees 13
12 minutes 46 seconds West, 151.14 feet to an iron pin; thence
13 run South 83 degrees 32 minutes 36 seconds East, 30.02 feet to
14 an iron pin; thence run North 89 degrees 13 minutes 52 seconds
15 East, 344 feet more or less to the Westerly margin of Wolf
16 Bay; thence run along the Westerly margin of Wolf Bay and the
17 Northerly margin of Owens Creek, 1212 feet more or less to the
18 East line of Lot 18, Cypress Cove Subdivision; thence run
19 North 00 degrees 07 minutes 43 seconds West, 783 feet to the
20 Point of Beginning. Together with an easement described as
21 follows: Beginning at the Northwest corner of Section 18,
22 Township 8 South, Range 5 East; thence run South 00 degrees 12
23 minutes 34 seconds East, 107.51 feet to an iron pin; thence
24 run South 00 degrees 25 minutes 13 seconds West, 259.96 to an
25 iron pin; thence run South 89 degrees 55 minutes 19 seconds

1 East, 50.00 feet to a point; thence run North 00 degrees 25
2 minutes 13 seconds East, 367.97 feet to a point; thence run
3 North 89 degrees 56 minutes 23 seconds West, 50.00 feet to an
4 iron pin and the Point of Beginning. (Pin 98309 Wolf Bay
5 Landing)

6 Tract 26:

7 As recorded in Instrument No. 1184479 in the records
8 of the office of Judge of Probate Court of Baldwin County,
9 Alabama:

10 That certain parcel of real property situate in the
11 Northeast Quarter of the Northeast Quarter of Section 7,
12 Township 8 South, Range 4 East, St. Stephens Meridian in
13 Baldwin County, Alabama; said parcel more particularly
14 described as follows:

15 Commencing at the Northeast corner of said Section 7
16 as monumented by railroad spike found in the center of
17 intersection of Hickory Lane and County Road 20;

18 Thence South 00 degrees 04 minutes 09 seconds West,
19 along the East line of said Section 7 a distance of 1329.00
20 feet to a point in the center of Hickory Lane; thence North 89
21 degrees 55 minutes 52 seconds West, along the South line of
22 the Northeast Quarter of the Northeast Quarter of said Section
23 7, a distance of 1334.53 feet to the Southwest corner of the
24 Northeast Quarter of the Northeast Quarter of said Section 7;
25 said point monumented by a #3 rebar; thence North 00 degrees

1 04 minutes 56 seconds East, along the West line of the
2 Northeast Quarter of said Section 7, a distance of 30.00 feet
3 to the Point of Beginning; said point monumented by a capped
4 rebar set by Gregory C. Spies, Surveyor; thence continuing
5 along said West line North 00 degrees 04 minutes 56 seconds
6 East, a distance of 240.00 feet to a point monumented by a
7 capped rebar set by Gregory C. Spies, Surveyor; thence South
8 00 degrees 04 minutes 56 seconds West, a distance of 240.00
9 feet to a point monumented by a capped rebar set by Gregory C.
10 Spies, Surveyor; thence North 89 degrees 55 minutes 52 seconds
11 West, a distance of 240.00 feet to the Point of Beginning.

12 Said Parcel containing 1.32 acres, more or less.

13 Together with a 30 foot wide non-exclusive
14 ingress/egress easement appurtenant to and augmenting the
15 above described parcel of real property; said easement more
16 particularly as follows:

17 Commencing at the Northeast corner of said Section 7
18 as monumented by railroad spike found in the center of
19 intersection of Hickory Lane and County Road 20; thence South
20 00 degrees 04 minutes 09 seconds West, along the section line
21 a distance of 1329.00 feet to a point in the center of Hickory
22 Lane; thence North 89 degrees 55 minutes 52 seconds West,
23 along the South line of the Northeast Quarter of the Northeast
24 Quarter of said Section 7, a distance of 30.60 feet, more or
25 less, to the Point of Beginning; said point located on the

1 West Right-of-way line of Hickory Lane; said point monumented
2 by a #5 rebar; thence continuing along the said South line
3 North 89 degrees 55 minutes 52 seconds West a distance of
4 1303.93 feet to a point monumented by a #3 rebar; said point
5 being the Southwest corner of the Northeast Quarter of the
6 Northeast quarter of said Section 7; thence North 00 degrees
7 04 minutes 56 seconds East, along the West line of the
8 Northeast quarter of the Northeast Quarter of said Section 7 a
9 distance of 30.000 feet to a point monumented by a capped
10 rebar set by Gregory C. Spies, Surveyor; thence South 89
11 degrees 55 minutes 52 seconds East, a distance of 1303.92
12 feet, more or less, to a point; said point located on the West
13 Right-of-way line of Hickory Lane; Thence south 00 degrees 04
14 minutes 09 seconds West, along said right-of-way line a
15 distance of 30.00 feet to the Point of Beginning; Said
16 Easement containing 0.90 acres, more or less. (Pin 315879 City
17 of Foley Utilities Board)

18 Tract 27:

19 As recorded in Map Book 3 Page 55 (Slide 127-A) in
20 the records of the office of Judge of Probate Court of Baldwin
21 County, Alabama:

22 Lot 14 Pine Grove Subdivision, being the Southeast
23 quarter of the Northeast quarter of Section 8, Township 8
24 South, Range 4 East, Baldwin County. (Pin 254324 Rawson)

25 Tract 28:

1 As recorded in Real Property Book 602 Page 1199 in
2 the records of the office of Judge of Probate Court of Baldwin
3 County, Alabama:

4 Commencing at the Southeast corner of the Northeast
5 Quarter of the Southeast Quarter of Section 8, Township 8
6 South, Range 4 East, Baldwin County, Alabama; thence run South
7 89 degrees 56 minutes 51 seconds West, 50 feet to a point on
8 the West right-of-way line of Highway Number 59; thence run
9 North 00 degrees, 07 minutes, 06 seconds West, along said
10 right-of-way, 166.38 feet to the Point of Beginning of the
11 property herein described; thence continue North 00 degrees 07
12 minutes 06 seconds West, along said right-of-way, 275.66 feet
13 to a point; thence run North 89 degrees 53 minutes 11 seconds
14 West, 345.97 feet to a point; thence run South 00 degrees 07
15 minutes 06 seconds East, 110.0 feet to a point; thence run
16 North 89 degrees 53 minutes 11 seconds West 269.97 feet to a
17 point; thence run North 00 degrees 08 minutes 15 seconds East,
18 110.92 feet to a point; thence run North 89 degrees 46 minutes
19 50 seconds West, 667.43 feet to a point; thence run South 00
20 degrees 01 minutes 35 seconds East, 220.69 feet to a point;
21 thence run South 89 degrees 40 minutes 54 seconds East, 666.80
22 feet to a point; thence run South 00 degrees 08 minutes 15
23 seconds West, 55.46 feet to a point; thence run South 89
24 degrees 57 minutes 13 seconds East, 616.68 feet to the Point
25 of Beginning. (Pin 82472 Rosser)

1 Tract 29:

2 As recorded in Real Property Book 96 Page 354 in the
3 records of the office of Judge of Probate Court of Baldwin
4 County, Alabama:

5 Commence at the Southeast corner of the Southeast
6 1/4 of the Northeast 1/4 of Section 20, Township 8 South,
7 Range 4 East, thence North along the East line of said 1/4 -
8 1/4 Section 40 feet thence 89 degrees 27 minutes left and
9 along the North right-of-way line of Baldwin County Road #10
10 450.0 feet, thence 89 degrees 27 minutes right 323.21 feet to
11 the Point of Beginning, thence 90 degrees 33 minutes right 400
12 feet to a point on the West right-of-way line of Alabama
13 Highway #59, thence 90 degrees 33 minutes left 100 feet thence
14 89 degrees 17 minutes left 400 feet, thence 90 degrees 33
15 minutes left 100 feet to the Point of Beginning. (Pin 30127
16 Molinaro)

17 Tract 30:

18 As recorded in Instrument No. 1406241 in the records
19 of the office of Judge of Probate Court of Baldwin County,
20 Alabama:

21 Commence at the Southwest corner of the Northeast
22 Quarter of the Northeast Quarter of Section 17, Township 7
23 South, Range 4 East for the Point of Beginning. Thence East
24 1276.6 feet to a point on the West right-of-way line of
25 Alabama Highway No.59, thence 90 degrees 5 1/2 minutes left

1 along said right-of-way line 300 feet; thence 89 degrees 54
2 1/2 minutes left 1,276.6 feet; thence 90 degrees 5 1/2 minutes
3 left 300 feet to the Point of Beginning. (Pin 77285 Sunsouth
4 Properties LLC)

5 Tract 31:

6 As recorded in Slide 2108-F in the records of the
7 office of Judge of Probate Court of Baldwin County, Alabama:

8 Lot 5, Ruegg Commercial Park. (Pin 262941 Faith
9 Tabernacle Inc.)

10 Tract 32:

11 As recorded in Real Property Book 708 Page 1119 in
12 the records of the office of Judge of Probate Court of Baldwin
13 County, Alabama:

14 Starting at a point 43.6 feet North and 150 feet
15 East of the Southwest Corner of the Southeast Quarter (SE 1/4)
16 of the Northwest Quarter (NW 1/4), Section Thirty (30),
17 Township Seven (7) South, Range (4) East, on the North line of
18 Alabama Highway No. 89 Right-of-way (now known as Alabama
19 Highway No. 98), run thence North 290.4 feet; run thence East
20 150 feet; run thence South 290.4 feet to a point on the said
21 North Right-of-way line; run thence West 150 feet to the Point
22 of Beginning, Less and Except any portion of subject property
23 lying within road Right-of-way. (Pin 3046 Grant)

24 Tract 33:

1 As recorded in Instrument No. 1089962 in the records
2 of the office of Judge of Probate Court of Baldwin County,
3 Alabama:

4 Commencing at the Southeast corner of the Northwest
5 quarter of Section 30, Township 7 South, Range 4 East, run
6 thence North along the East line of said Northwest Quarter 40
7 feet, more or less, to a point on the North right-of-way line
8 of US Highway 98, thence run Westerly along said North
9 right-of-way line 15 feet to a point on the West line of the
10 30 foot county right-of-way, thence run Westerly along said
11 North right-of-way line 167.5 feet to the Point of Beginning,
12 thence run 145.2 feet, thence run westerly parallel to said
13 Highway 98 150 feet, then run South 145.2 feet to a point on
14 the North right-of-way line of US Highway 98, thence run East
15 150 feet to the Point of Beginning. (Pin 15863 Ortho Clubhouse
16 LLC)

17 Tract 34:

18 As recorded in Instrument No. 1100701 in the records
19 of the office of Judge of Probate Court of Baldwin County,
20 Alabama:

21 Being a parcel of land lying in the Northeast 1/4 of
22 Section 30, Township 7 South, Range 4 East, Baldwin County,
23 Alabama, and also being more particularly described as
24 follows: Commencing at the Northwest Corner of said Section
25 30; thence South 89 degrees 59' 06" East, 2680.02 feet; thence

1 South 00 degrees 32'48" West, 2640.10 feet to the North
2 right-of-way of US Highway 98; thence South 89 degrees 44' 33"
3 East along said right-of-way, 600.00 feet; thence South 00
4 degrees 32' 48" West, 46.00 feet to the approximate centerline
5 of said Highway and the Point of Beginning of the parcel
6 herein described; thence North 00 degrees 32' 48" East,
7 1016.40 feet; thence South 89 degrees 27' 07" East, 300.00
8 feet; thence South 00 degrees 32' 48" West, 1016.40 feet to
9 said centerline; thence North 89 degree 27' 07" West, along
10 said centerline, 300.00 feet to the Point of Beginning. (Pins
11 273321, 231281 King)

12 Tract 35:

13 As recorded in Instrument No. 659314 in the records
14 of the office of Judge of Probate Court of Baldwin County,
15 Alabama:

16 The Southeast Quarter of the Northeast Quarter of
17 Section 30, Township 7 South, Range 4 East. (Pin 41945 Taylor)

18 Tract 36:

19 As recorded in Real Property Book 771 Page 909 in
20 the records of the office of Judge of Probate Court of Baldwin
21 County, Alabama:

22 Commencing at the Southwest corner of Section 9,
23 Township 7 South, Range 4 East; run thence East along the
24 North line of said Section 9 a distance of 815.7 feet to a
25 point; thence run North a distance of 40 feet to a point on

1 the North right of way line of Harney Road, an 80 foot right
2 of way and the point of beginning of the property herein
3 described; thence continue North a distance of 580.00 feet to
4 a point; thence run South $89^{\circ} 55' 27''$ West, a distance of
5 600.00 feet to a point; thence run North $00^{\circ} 11' 13''$ East, a
6 distance of 700.00 feet to a point; thence run North 89°
7 $55' 27''$ East, a distance of 1,083.20 feet to a point on the
8 West line of a 60 foot right of way; thence run South $00^{\circ} 11'$
9 $13''$ West, along said West right of way line a distance of
10 700.00 feet to a point; thence run South $89^{\circ} 55' 27''$ West, a
11 distance of 200.00 feet to a point; thence run South a
12 distance of 580 feet to a point on the North line of said
13 Hadley Road, an 80 foot right of way; thence run West along
14 the North line of said right of way a distance of 283.20 feet
15 to the Point of Beginning. Contains 21.18 acres. (Pin 21332,
16 Langford).

17 Tract 37:

18 As recorded in Real Property Book 488 Page 171 in
19 the records of the office of Judge of Probate Court of Baldwin
20 County, Alabama:

21 The East half of the West half of the Southeast
22 Quarter of Section 9, Township 8 South, Range 4 East, Baldwin
23 County, Alabama. (Pin 90215_Victory Life Church)

24 Tract 38:

1 As recorded on Instrument No. 1264547 in the records
2 of the office of Judge of Probate Court of Baldwin County,
3 Alabama:

4 The West Half of the East Half of the Southeast
5 Quarter of Section 9, Township 8 South, Range 4 East, Baldwin
6 County, Alabama. (Pin 91555_Young Family Limited Partnership)

7 Tract 39:

8 As recorded in Real Property Book 304 Page 1061 in
9 the records of the office of Judge of Probate Court of Baldwin
10 County, Alabama:

11 The south 527.40 feet of the East 665.00 feet of the
12 Southeast Quarter of Section 9, Township 8 South, Range 4 East
13 less the East 20.00 feet and the South 40.00 feet for road
14 right-of-way containing 8.00 acres, more or less, Baldwin
15 County, Alabama. (Pin 91557_Young)

16 Tract 40:

17 As recorded in Real Property Book 189 Page 1415 in
18 the records of the office of Judge of Probate Court of Baldwin
19 County, Alabama:

20 Commence at the Northwest corner of Section 10,
21 Township 8 South, Range 4 East; run thence East along the
22 North line of said Section 10 for 1,166.2 feet to the Point of
23 Beginning; run thence South for 287.83 feet; run thence East
24 for 101.3 feet; run thence North 287.83 feet to the North line
25 of Section 10, Township 8 South, Range 4 East; run thence West

1 101.3 feet along Section line to the Point of Beginning. Said
2 land being in Section 10, Township 8 South, Range 4 East,
3 Baldwin County, Alabama, LESS AND EXCEPT the North 40.0 feet
4 of the above described property for a right of way of County
5 Road No. 20. (Pin 54282_Cruz)

6 Tract 41:

7 As recorded on Instrument No. 1473505 in the records
8 of the office of Judge of Probate Court of Baldwin County,
9 Alabama:

10 Commencing at the purported Northwest corner of
11 Section 10, Township 8 South, Range 4 East, Baldwin County,
12 Alabama; thence south 00 degrees 13 minutes 00 seconds east, a
13 distance of 1418.61 feet to a point; thence north 89 degrees
14 47 minutes 00 seconds east, a distance of 40.0 feet to a point
15 on the east right-of-way line of James Road (80' right-of-way)
16 said point being the point of beginning; thence continue north
17 89 degrees 47 minutes 00 seconds east along said line, a
18 distance of 363.00 feet to a point; thence south 00 degrees 13
19 minutes 00 seconds east, a distance of 120.00 feet to a point;
20 thence south 89 degrees 47 minutes 00 seconds west, a distance
21 of 363.00 feet to a point on the above mentioned east
22 right-of-way of James Road; thence north 00 degrees 13 minutes
23 00 seconds west, along said right-of-way a distance of 120.00
24 feet to the point of beginning. said land being a portion of

1 James Corners subdivision as recorded on slide 2216 d & e.

2 (Pin 342291_Walker)

3 Tract 42:

4 As recorded in Real Property Book 219 Page 240 in
5 the records of the office of Judge of Probate Court of Baldwin
6 County, Alabama:

7 Commence at the Northwest corner of Section 10,
8 Township 8 South, Range 4 East; run thence South 00° 02' 57"
9 East for 1538.61 feet; run thence North 89° 57' 03" East for
10 20 feet to the East Right-of-Way of a 40' dirt road for the
11 Point of Beginning; run thence North 89° 57' 03" East for
12 187.7 feet; run thence South 00° 02' 57" East for 116.04 feet;
13 run thence South 89° 57' 03" West for 187.7 feet to said East
14 Right-of-Way of 40' dirt road; run thence North 00° 02' 57"
15 West along said East Right-of-Way for 116.04 feet to the Point
16 of Beginning. Said land being in Section 10, Township 8 South,
17 Range 4 East, Baldwin County, Alabama. (Pin 60062_Pumphrey).

18 Tract 43:

19 As recorded on Slide 2216-E in the records of the
20 office of Judge of Probate Court of Baldwin County, Alabama:

21 The 55.96 acres, Parcel Number
22 61-02-10-0-000-004.000, outparcel of James Corner subdivision
23 per plat recorded by Laurence H. Zander, PLS dated March 2005.
24 (Pin 21868_Callaway).

25 Tract 44:

1 As recorded on Instrument No. 1664586 in the records
2 of the office of Judge of Probate Court of Baldwin County,
3 Alabama:

4 Lot 1, Little Woerner Subdivision, according to the
5 map or plat thereof recorded on Slide 2617-A in the Office of
6 Judge of Probate of Baldwin County, Alabama. (Pin
7 376297_Woerner)

8 Tract 45:

9 As recorded on Instrument No. 1347935 in the records
10 of the office of Judge of Probate Court of Baldwin County,
11 Alabama:

12 110' x 145' (S) Beg at the NE corner of the NE 1/4
13 the NE 1/4 run S 663' (S), TH W 255' (S) for the POB, TH run S
14 110' (S), TH W 145' (S), TH N 110', TH E 145' (S) to the POB.
15 (Pin 1486_McCroan)

16 Section 2. In accordance with Section 11-42-6, Code
17 of Alabama 1975, a map showing the proposed territory to be
18 annexed to the City of Foley is on file in the office of the
19 Judge of Probate in Baldwin County, Alabama, and the map is
20 open to the inspection of the public.

21 Section 3. This act shall become effective
22 immediately following its passage and approval by the
23 Governor, or its otherwise becoming law.

1
2
3
4
5
6
7
8
9
10
11
12
13
14
15
16
17

Mac McClatchey

Speaker of the House of Representatives

[Signature]

President and Presiding Officer of the Senate

House of Representatives

I hereby certify that the within Act originated in
and was passed by the House 07-MAY-19.

Jeff Woodard
Clerk

Senate

29-MAY-19

Passed

APPROVED

6/4/19

TIME

4:35pm

Kay Ivey

GOVERNOR

Alabama Secretary Of State

Act Num....: 2019-363
Bill Num...: H-483

Recv'd 06/05/19 11:16amSL

JEFF WOODARD,
Clerk
LLZ

HOUSE ACTION

DATE: 2/21 2019
RD 1 RFD BCL

REPORT OF STANDING COMMITTEE
This bill having been referred by the House to its standing committee on _____ was _____
acted upon by such committee in ses-
sion, and returned therefrom to the
House with the recommendation that it be
Passed w/amend(s) _____ w/sub _____
this 22nd day of May 20 19
[Signature] Chairperson

DATE: 5-2 2019
RF RD 2 CAL

DATE: 20
RE-REFERRED RE-COMMITTED
Committee _____

I hereby certify that the Resolution as
required in Section C of Act No. 81-889
was adopted and is attached to the Bill,
HB 483
YEAS 41 NAYS 0



City of Foley 2019 Legislative Annexation NE Quad

STATE OF ALABAMA

2019 MAR 20 A 8:30

BALDWIN COUNTY

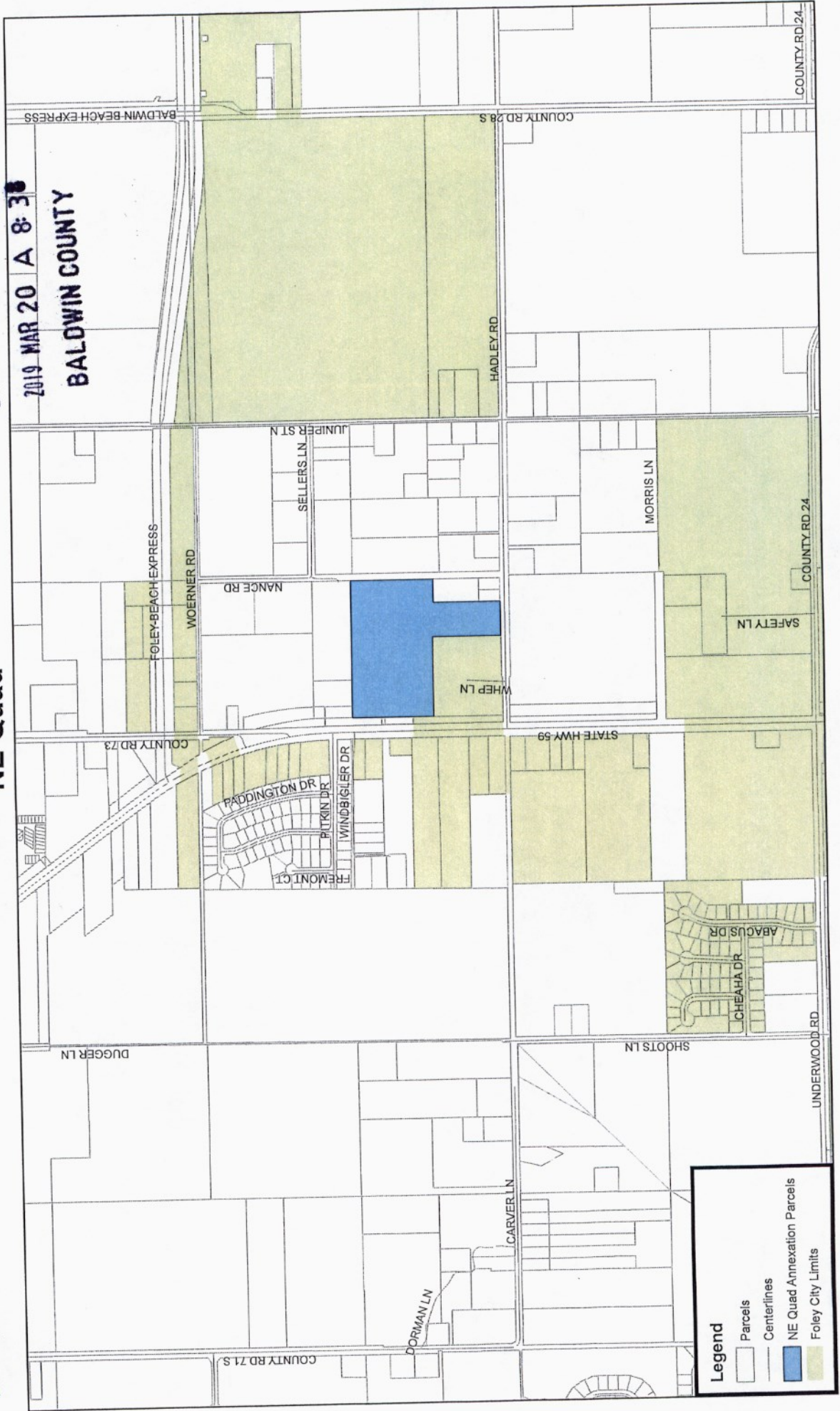

City of Foley 2019 Legislative Annexation SW Quad

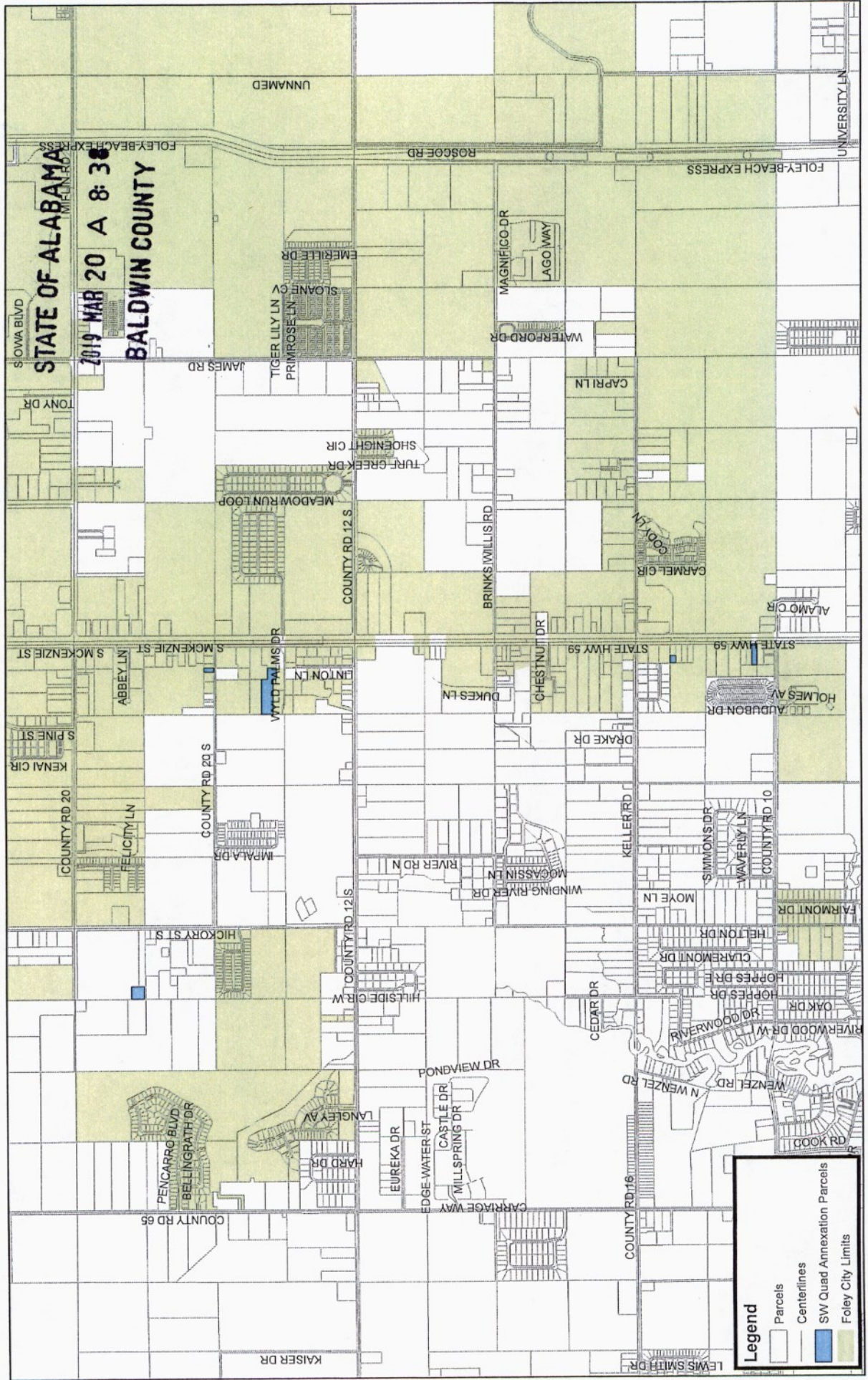



STATE OF ALABAMA

2010 MAR 20 01:48 PM

BALDWIN COUNTY

