



30673 Sgt E.I. "Boots" Thomas Dr.  
Spanish Fort, AL 36527  
P: 251-544-7900  
[www.sawgrassllc.com](http://www.sawgrassllc.com)

June 14, 2024

Mr. David Thompson  
City of Foley  
P.O. Box 1750  
Foley, Alabama 36535

**RE: Foley Pickleball Court Complex and Parking Facility – Change Order Request to Professional Services**

Dear David,

Sawgrass Consulting, LLC, (Sawgrass) has been asked to add additional courts (3) to the existing project scope of our contracted professional services for final development of the Pickleball Recreation Facility. This extension of the existing plan(s) is estimated to increase the value of the project in excess of \$220,000, which includes earthwork, drainage, base, paving, fencing, ribbon curb, final court surfacing, lighting coordination, benches, sidewalk and any other features related to the final pickleball court product. In addition to the design changes, the duration of the inspection services will also increase due to the time to construct the additional courts. In summary, the following cost for the project is as follows:

<b><u>Ph1a -Civil - Parking Lots/Sidewalk/Drainage/Court (base)</u></b>	
Plan Revisions/Modifications	\$2,000.00
Construction Observation	\$4,000.00 (Hourly NTE)
 <b><u>Ph2-Landscape Arch- Hardscape/Sports Courts/Landscape</u></b>	
Construction Document Adjustments	\$5,900.00
Construction Observation	\$4,000.00
 <b>Total    \$15,900.00</b>	

We appreciate the opportunity to partner with the City on this Project and please do not hesitate to call if you have any questions or need to discuss this Proposal in more detail.

Sincerely,

A handwritten signature in blue ink, appearing to read 'Stephen Delahunty'.

Stephen Delahunty, P.E.  
President

Enclosures

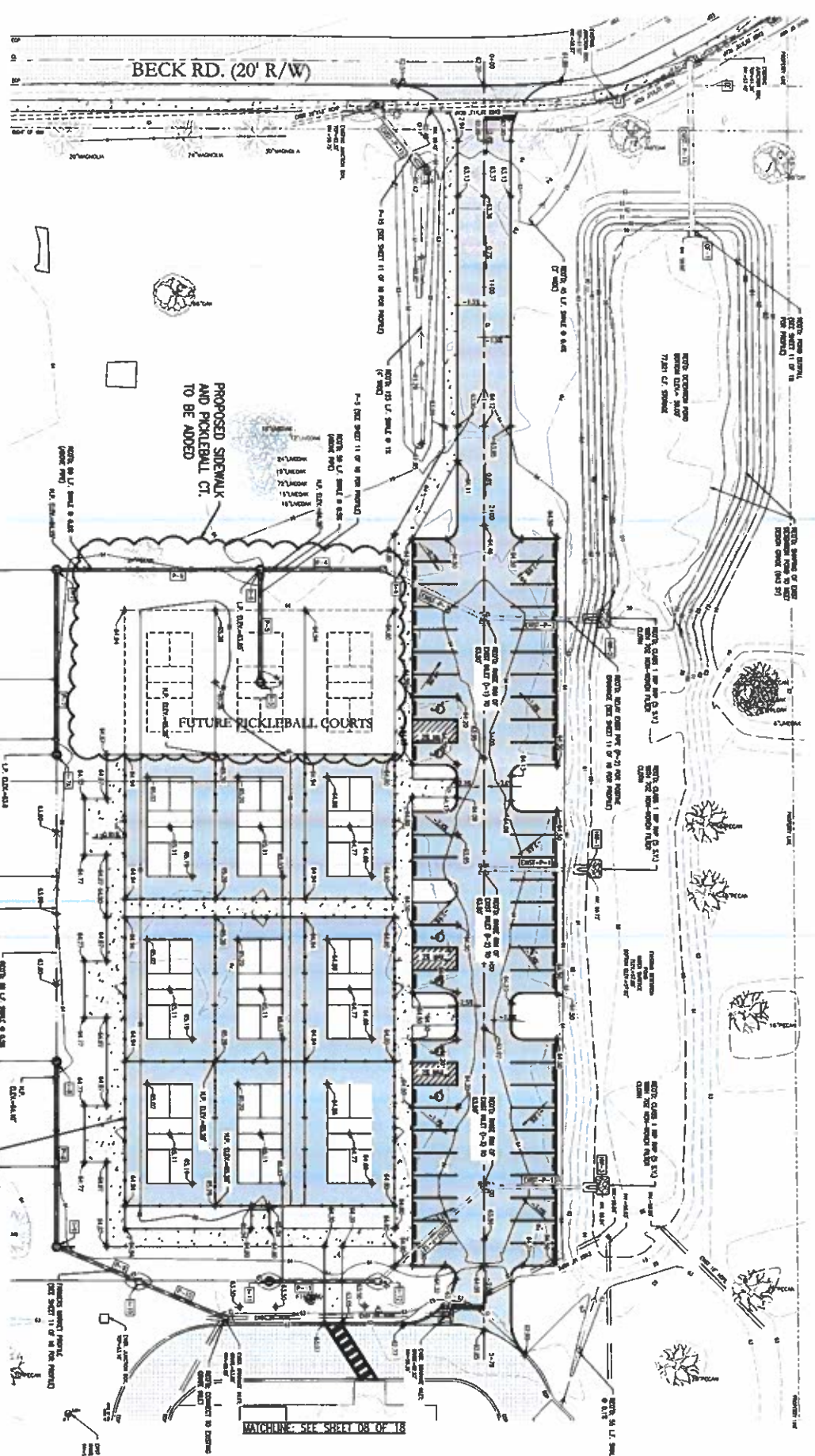

BECK RD. (20' R/W)

PROPOSED SIDEWALK AND PICKLEBALL CT. TO BE ADDED

FUTURE PICKLEBALL COURTS

- LEGEND**
- EXISTING SIDEWALK
  - PROPOSED SIDEWALK
  - EXISTING PICKLEBALL COURT
  - PROPOSED PICKLEBALL COURT
  - EXISTING UTILITY
  - PROPOSED UTILITY
  - EXISTING LANDSCAPE
  - PROPOSED LANDSCAPE



EXISTING DESIGN  
FARMERS MARKET PICKLEBALL PARK  
FOLEY, ALABAMA

SCALE: 1"=20'  
DATE: MAY 2003  
DRAWN BY: [Name]  
CHECKED BY: [Name]  
SHEET: 07 OF 10