



City of Foley, AL

407 E. Laurel Avenue
Foley, AL 36535

Signature Copy

Resolution: 24-1170-RES

File Number: 24-0249

Enactment Number: 24-1170-RES

A Resolution Approving and Appropriating Funds for Four (4) Sidewalk Projects.

WHEREAS, Street Department has received estimates for the construction of four (4) Sidewalk Project throughout Foley, and

WHEREAS, Street Department is requesting to approve three (3) of the projects and appropriate \$180,000.00 for these services.

NOW THEREFORE BE IT RESOLVED that the City Council of the City of Foley, Alabama, as follows:

SECTION 1: Approves the sidewalk projects for Foley High School, Mathis Elementary School, and Foley Elementary School (Option 1).

SECTION 2: Approves the James Brothers Excavating estimates in the amount of \$88,242.00 for the Highway 59 Sidewalk, \$40,044.29 for the Foley High School Sidewalk, \$23,962.50 for the Mathis Elementary School Sidewalk, and \$23,988.00 for the Foley Elementary School Sidewalk Option 1.

SECTION 3: Appropriates \$180,000.00 under Account # 400-3010-5101 A23 School.

SECTION 4: This Resolution shall become effective immediately upon its adoption as required by law.

PASSED, APPROVED AND ADOPTED this 15th day of April 2024.

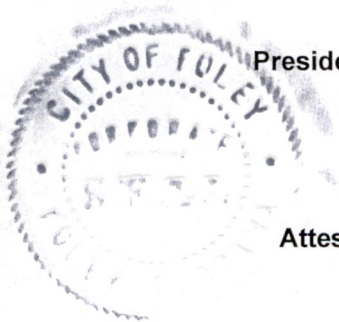

President's Signature

[Handwritten Signature]

Date

4-15-24

Attest by City Clerk

[Handwritten Signature]

Date

4-15-24

Mayor Signature

[Handwritten Signature]

Date

4/15/24

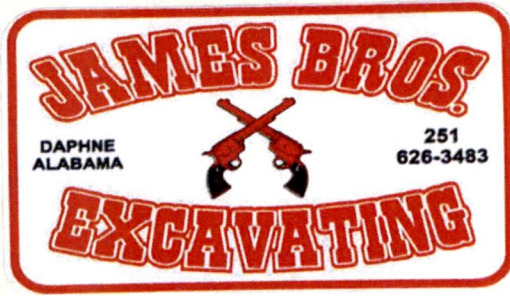

**JOB NAME: Foley Elementary @ Rose Ave
Open Ditch**

ITEM NO.	ITEM DESCRIPTION	EST QTY	UNIT MEA	UNIT PRICE	TOTAL BID PRICE
1	New Section of Sidewalk	800	SF	\$ 10.00	\$ 8,000.00
3	Doweling new concrete every 16'	5	SF	\$ 14.00	\$ 70.00
43	Sod	135	SF	\$ 6.00	\$ 810.00
44	ADA Detectable Warning Pads 2x4	1	EA	\$ 822.00	\$ 822.00
45	Demolition of Existing 24" Headwall	1	EA	\$ 1,786.00	\$ 1,786.00
45	24" Vertical Headwall	1	EA	\$ 7,250.00	\$ 7,250.00
45	Aluminum Handrail	30	LF	\$ 175.00	\$ 5,250.00
TOTAL AMOUNT BID					\$ 23,988.00

Notes: City to slope from sidewalk to existing ground.
Material to be disposed in City pit.

Drainage & Inlets

ITEM NO.	ITEM DESCRIPTION	EST QTY	UNIT MEA	UNIT PRICE	TOTAL BID PRICE
1	New Section of Sidewalk	830	SF	\$ 10.00	\$ 8,300.00
3	Doweling new concrete every 16'	5	SF	\$ 14.00	\$ 70.00
7	Transition Box	2	EA	\$ 6,000.00	\$ 12,000.00
43	Sod	135	SF	\$ 6.00	\$ 810.00
44	ADA Detectable Warning Pads 2x4	1	EA	\$ 822.00	\$ 822.00
45	Demolition of Existing 24" Headwall	1	EA	\$ 1,786.00	\$ 1,786.00
45	12" ADS	200	LF	\$ 81.00	\$ 16,200.00
45	24" RCP with Concrete Collar	8	LF	\$ 395.00	\$ 3,160.00
45	Aluminum Handrail	30	LF	\$ 175.00	\$ 5,250.00
TOTAL AMOUNT BID					\$ 48,398.00

Notes: 12" ADS maximum pipe size for transition box on upstream side to function.
Transition box at Rose ave will have knock for flow the enter from the west.
Transition box upstream in a 4 way pedestal weir.
Material to be disposed in City pit.

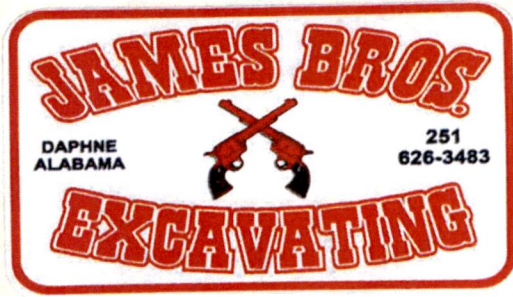

JOB NAME: Mathis School Tie-In

ITEM NO.	ITEM DESCRIPTION	EST QTY	UNIT MEA	UNIT PRICE	TOTAL BID PRICE
1	New Section of Sidewalk	690	SF	\$ 10.00	\$ 6,900.00
2	R/R existing Sidewalk	1365	SF	\$ 12.50	\$ 17,062.50
TOTAL AMOUNT BID					\$ 23,962.50

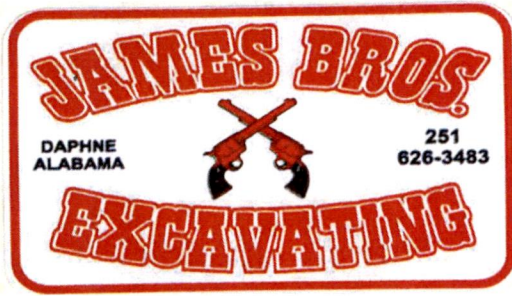

JOB NAME: Foley High School

ITEM NO.	ITEM DESCRIPTION	EST QTY	UNIT MEA	UNIT PRICE	TOTAL BID PRICE
1	New Section of Sidewalk	2,575	SF	\$ 10.00	\$ 25,750.00
43	Sod	1370	SF	\$ 6.00	\$ 8,220.00
44	ADA Detectable Warning Pads 2x4	5	EA	\$ 822.00	\$ 4,110.00
45	River Rock	5	Tons	\$ 392.86	\$ 1,964.29
TOTAL AMOUNT BID					\$ 40,044.29

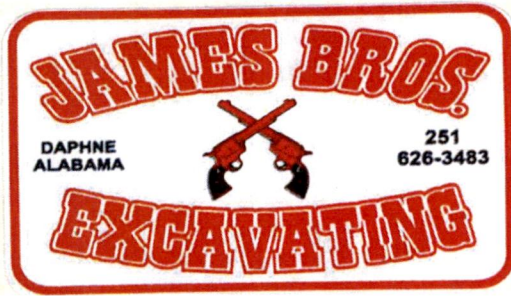

JOB NAME: Hwy 59 Sidewalk

ITEM NO.	ITEM DESCRIPTION	EST QTY	UNIT MEA	UNIT PRICE	TOTAL BID PRICE
1	New Section of Sidewalk	1,929	SF	\$ 10.00	\$ 19,290.00
2	R/R Existing Sidewalk	225	SF	\$ 12.50	\$ 2,812.50
5	Type C Curb new & R/R	51	LF	\$ 68.00	\$ 3,468.00
7	Transition box	2	SF	\$ 6,000.00	\$ 12,000.00
29	Type C C&G	71	LF	\$ 58.00	\$ 4,118.00
43	Sod	900	SF	\$ 6.00	\$ 5,400.00
44	ADA Detectable Warning Pads 2x4	10	EA	\$ 822.00	\$ 8,220.00
45	Misc Items/ ADA Ramp Type 2	2	EA	\$ 3,250.00	\$ 6,500.00
45	Sawcut Demo Asphalt	375	SF	\$ 11.50	\$ 4,312.50
45	Misc/ Demo Headwall End Treatment Flume	1	LS	\$ 3,572.00	\$ 3,572.00
45	Misc/ Connect to Existing Inlet	1	LS	\$ 2,143.00	\$ 2,143.00
45	Misc/12" PVC	60	LF	\$ 115.00	\$ 6,900.00
45	Concrete Collar	1	EA	\$ 1,072.00	\$ 1,072.00
45	Traffic Control	1	LS	\$ 5,179.00	\$ 5,179.00
45	Silt Fence	310	LF	\$ 10.50	\$ 3,255.00
TOTAL AMOUNT BID					\$ 88,242.00

Directions:

Please complete all questions below and submit to Mike Thompson and Wayne Trawick for approval.
If this project is approved, you must complete the Pre-Project Worksheet and Budget forms.

Submitted by: Darrell Russell

Date Submitted: 5-Apr-24

Is this purchase listed on the capital projects plan in the approved budget? YES

What amount is approved in the plan for this project? \$1M PLANNED, ASKING FOR \$180K

In what year is this project shown to begin in the plan? FY 24

Description of the project and why the project needs to be completed at this time.
NEW SIDEWALKS ARE A PRIORITY FOR CONNECTIVITY WITHIN OUR CITY LIMITS. THESE SIDEWALKS WILL AID THE PEDESTRIAN TRAFFIC DOWNTOWN, AND FOR OUR SCHOOLS.

Can your job be performed without the completion of this project? Please explain below.
N/A

Will not completing this project cause a public safety issue? Please explain below.
YES, WE ARE IN NEED OF SIDEWALKS TO KEEP PEOPLE OUT OF THE ROAD.

Do you expect to come in, at, or under budget on this project? Please explain below.
N/A

Is there a grant associated with this project? No
If so please list below the grant amount and the match required by the City.

Approval by City Administrator Mike Thompson 4/15/24
Signature and Date

Approval by Council President Wayne Trawick 4-15-24
Signature and Date

Foley Elementary School

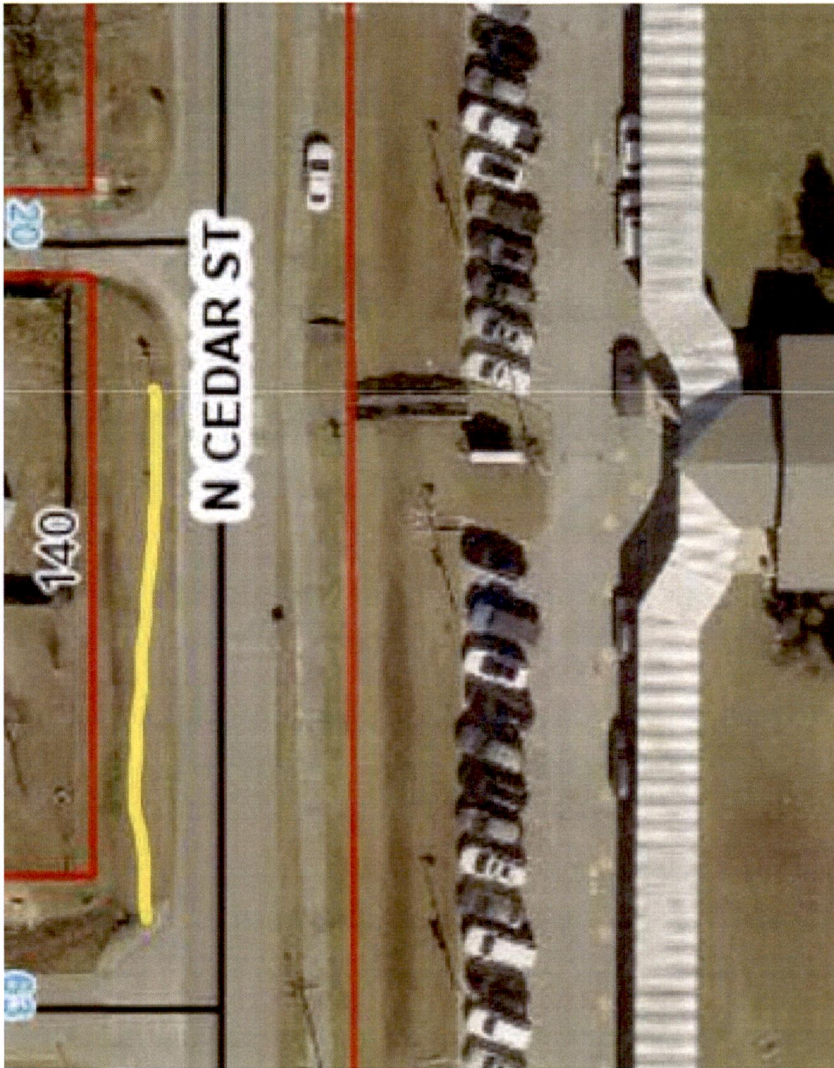

Mathis Elementary School



Hwy 59



Foley High School

