



City of Foley, AL

407 E. Laurel Avenue
Foley, AL 36535

Signature Copy

Resolution: 25-1045-RES

File Number: 25-0063

Enactment Number: 25-1045-RES

A Resolution to Approve Funding for Pilgrim Street Extension and Permission to Go to Bid.

WHEREAS, Pilgrim is a planned City constructed road project for FY24 that has gone into FY25, AND

WHEREAS, Pilgrim design was changed to include an all purpose walking path for an additional \$2,200.00, AND

WHEREAS, the Street Department is requesting \$600,000.00 under Account #400-3010-5100 CR-9, AND

WHEREAS, the Street Department seeks permission to go to bid for the asphalt surfacing and masonry work.

NOW THEREFORE BE IT RESOLVED that the City Council of the City of Foley, Alabama, as follows:

SECTION 1: Appropriates \$600,00.00 under account #400-3010-5100 CR-9.

SECTION 2: Approves permission for Street Department to go to bid for the asphalt paving component and masonry work of the road building project.

SECTION 3: This Resolution shall become effective immediately upon its adoption as required by law.

PASSED, APPROVED AND ADOPTED this 17th, day of February, 2025.

President Signature

Date

2-17-25

Attest by City Clerk

Date

2-17-25

Mayor Signature

Date

2-17-25

PILGRIM STREET (E. MICHIGAN AVE. TO E. JACKSON AVE.) PILGRIM ALL PURPOSE TRAIL (E. JACKSON AVE. TO E. JEFFERSON AVE.) PILGRIM ST., FOLEY, ALABAMA 36535 CONSTRUCTION DRAWINGS

JANUARY, 2025

INDEX OF SHEETS	
SHEET NUMBER	SHEET TITLE
01	TITLE SHEET
02	PROJECT NOTES
03	EXISTING CONDITIONS & DEMO PLAN 1
04	EXISTING CONDITIONS & DEMO PLAN 2
05	EXISTING CONDITIONS & DEMO PLAN 3
06	GEOMETRY PLAN 1
07	GEOMETRY PLAN 2
08	GEOMETRY PLAN 3
09	ALL PURPOSE TRAIL PLAN PROFILE
10	PLAN AND PROFILE SOUTH
11	CROSS SECTIONS ALL PURPOSE TRAIL
12	CROSS SECTIONS
13	CROSS SECTIONS
14	CIVIL CONSTRUCTION DETAILS
15	CIVIL CONSTRUCTION DETAILS 2
16	EROSION CONTROL PLAN 1
17	EROSION CONTROL PLAN 2
18	EROSION CONTROL PLAN 3
19	EROSION CONTROL DETAILS

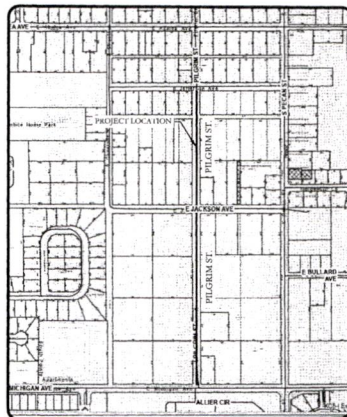

VICINITY MAP

PREPARED BY:

Pillar

MAYOR
HONORABLE RALPH HELLMICH

COUNCIL MEMBERS

J. WAYNE TRAWICK	DISTRICT 1
VERA J. QUAITES	DISTRICT 2
RICHARD DAYTON	DISTRICT 3
C. RICK BLACKWELL	DISTRICT 4
CHARLES J. EBERT III	DISTRICT 5



ENGINEER OF RECORD	_____ DATE
CITY ENGINEER	_____ DATE

[illegible][illegible][illegible]

1. THE CONTRACTOR SHALL CLEAR ALL TREES/SHRUBBERY/DEBRIS WITHIN THE DESIGNATED CONSTRUCTION EASEMENTS & PROJECT LIMITS UNLESS OTHERWISE DIRECTED BY THE ENGINEER (ALL SITES).

THOMAS GRANGER, P.E., PILLAR
(251) 295-6921

Pillar

PROJECT NOTES
PILGRIM STREET
CITY OF FOLEY



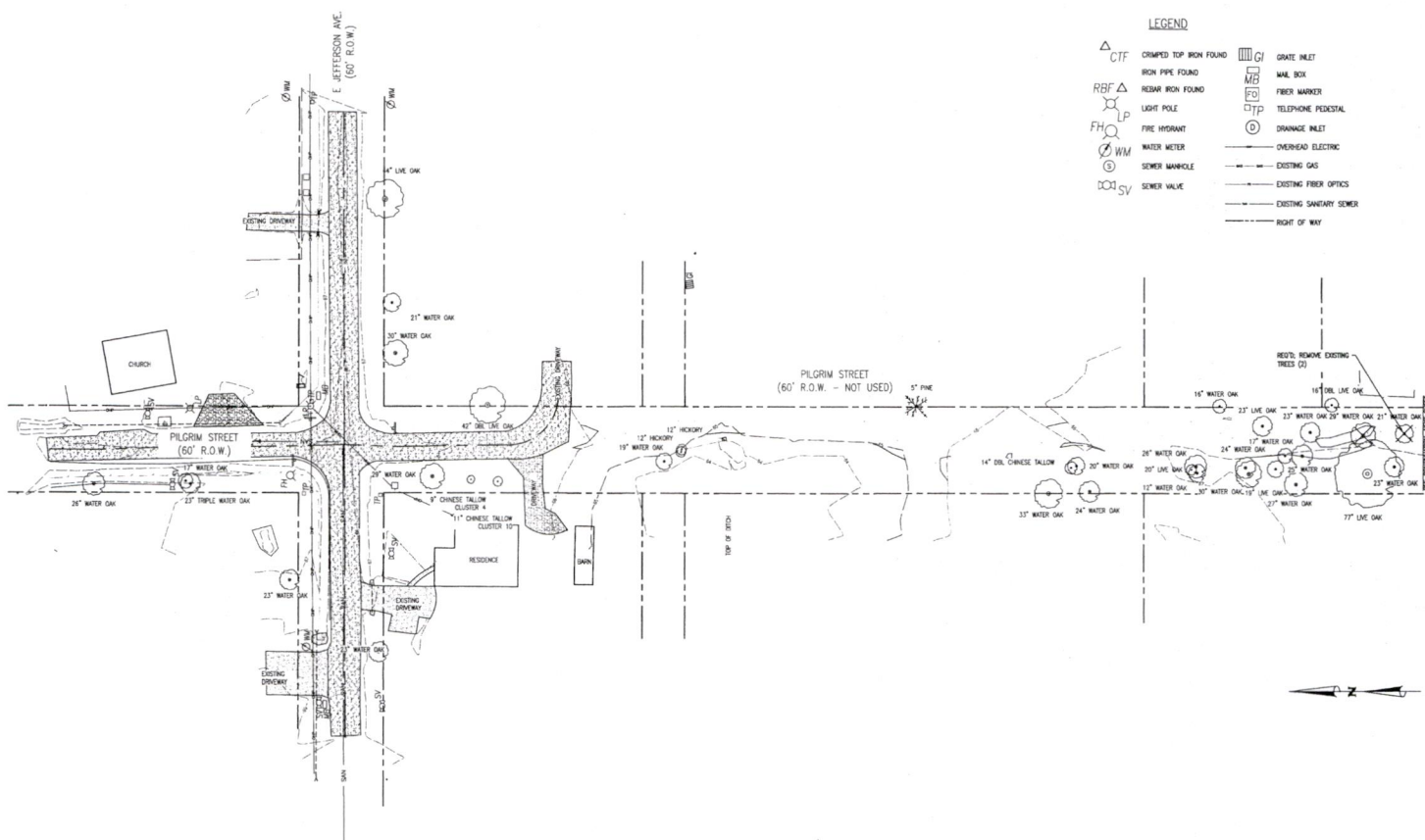

NUMBER:	REVISION:	DATE:

Pillar



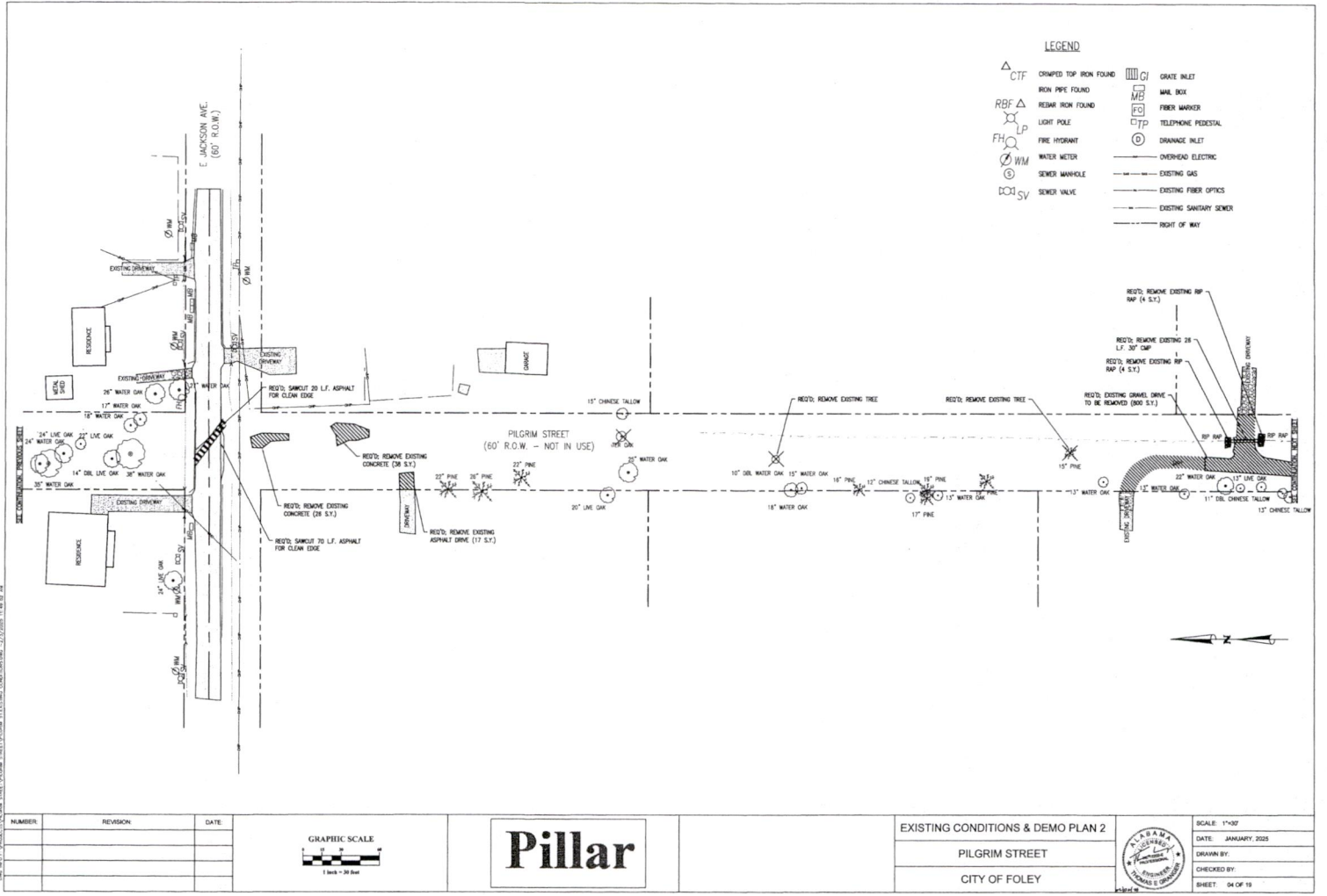

LEGEND

- | | | | |
|---------------|------------------------|--------------|-------------------------|
| Δ CTF | CRIMPED TOP IRON FOUND | \square GI | GRATE INLET |
| \square RBF | IRON PIPE FOUND | \square MB | MAIL BOX |
| \square LP | REBAR IRON FOUND | \square FO | FIBER MARKER |
| \square FH | LIGHT POLE | \square TP | TELEPHONE PEDESTAL |
| \square WM | FIRE HYDRANT | \square D | DRAINAGE INLET |
| \square WM | WATER METER | — | OVERHEAD ELECTRIC |
| \square SV | SEWER MANHOLE | — | EXISTING GAS |
| \square SV | SEWER VALVE | — | EXISTING FIBER OPTICS |
| | | — | EXISTING SANITARY SEWER |
| | | — | RIGHT OF WAY |

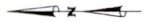
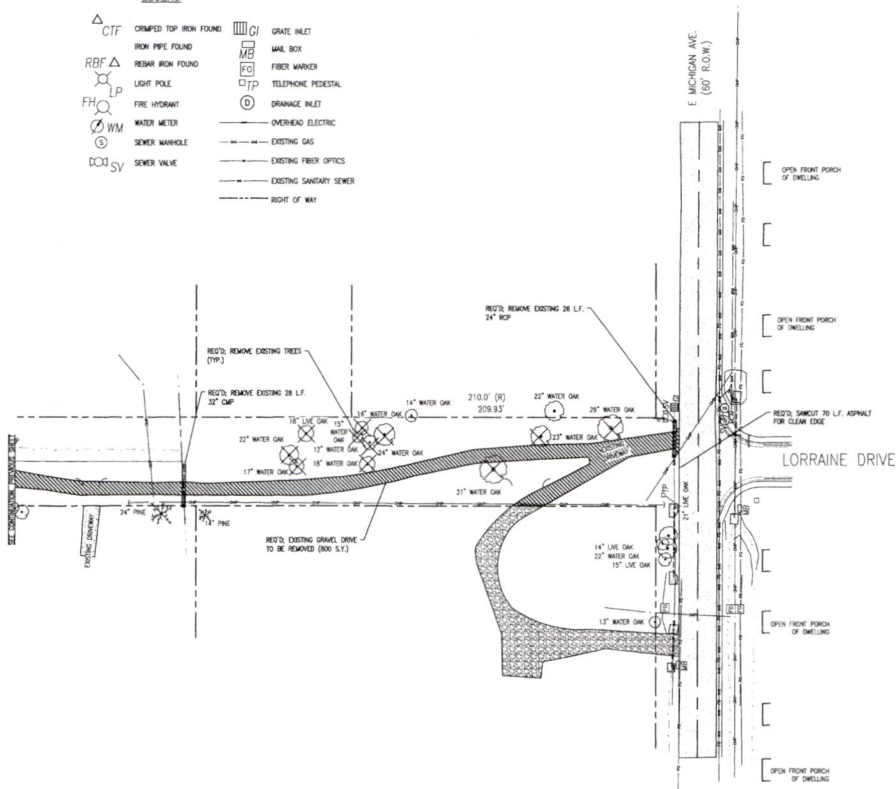

NUMBER	REVISION	DATE



Pillar

EXISTING CONDITIONS & DEMO PLAN 3
PILGRIM STREET
CITY OF FOLEY



SCALE: 1"=30'
DATE: JANUARY, 2025
DRAWN BY:
CHECKED BY:
SHEET: 05 OF 19

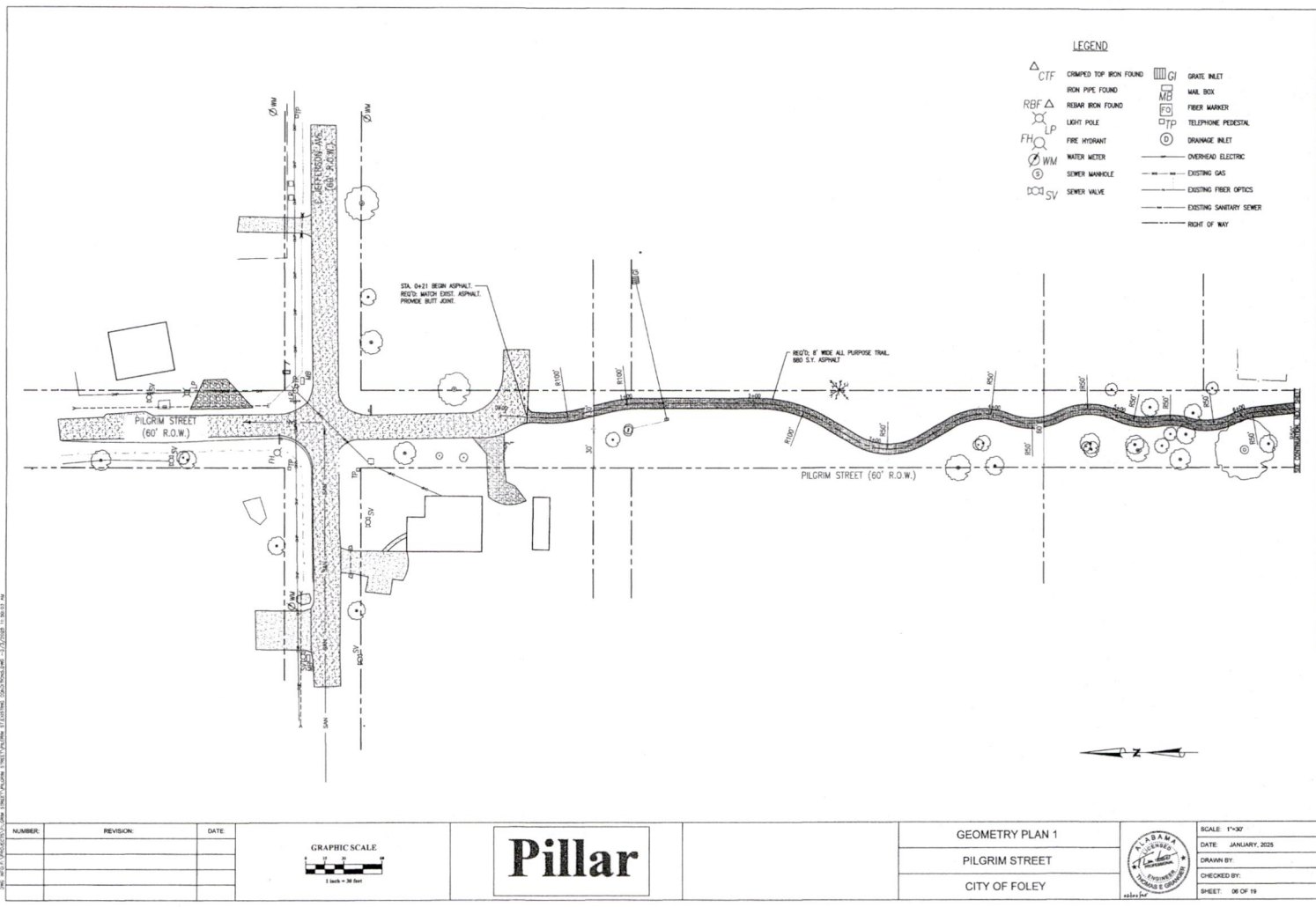

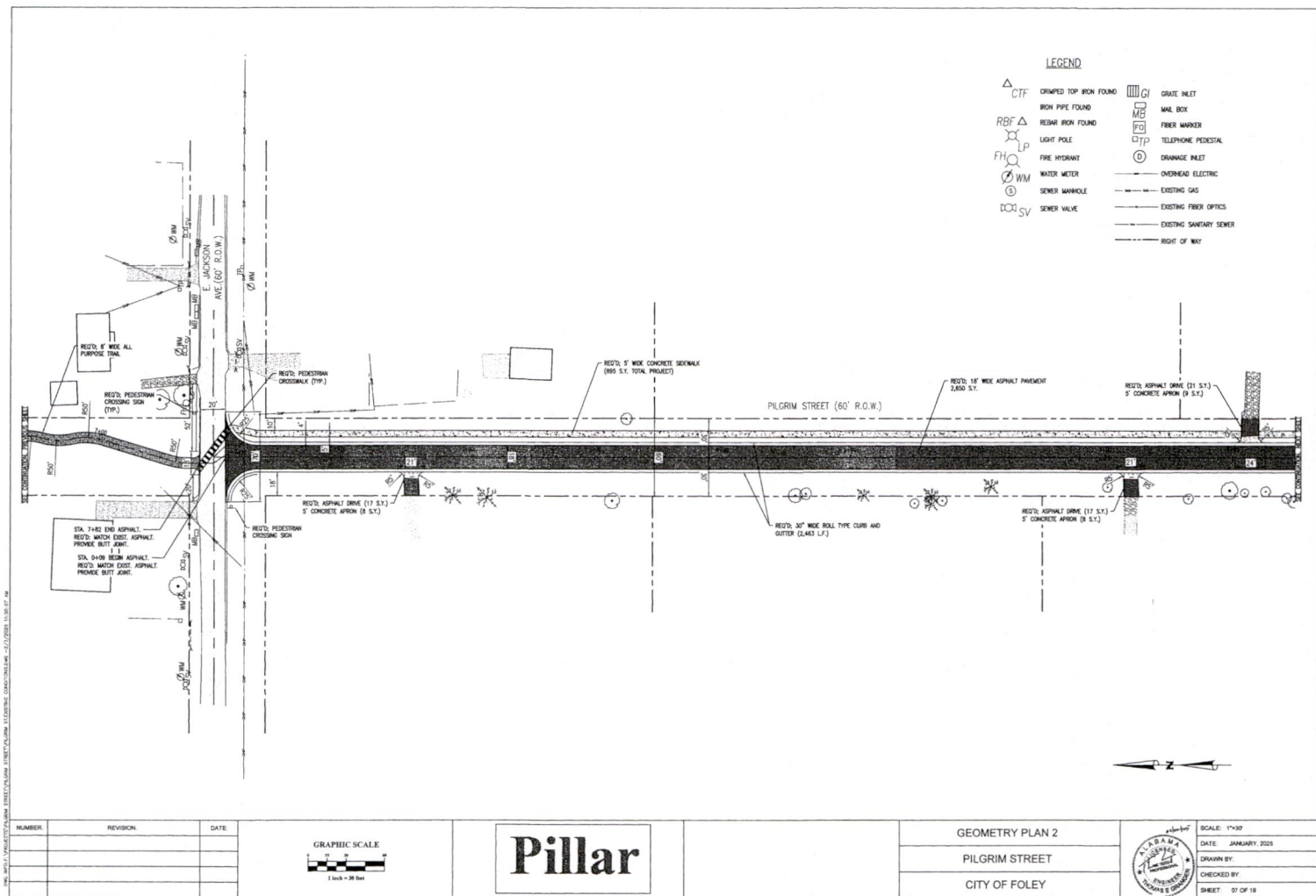

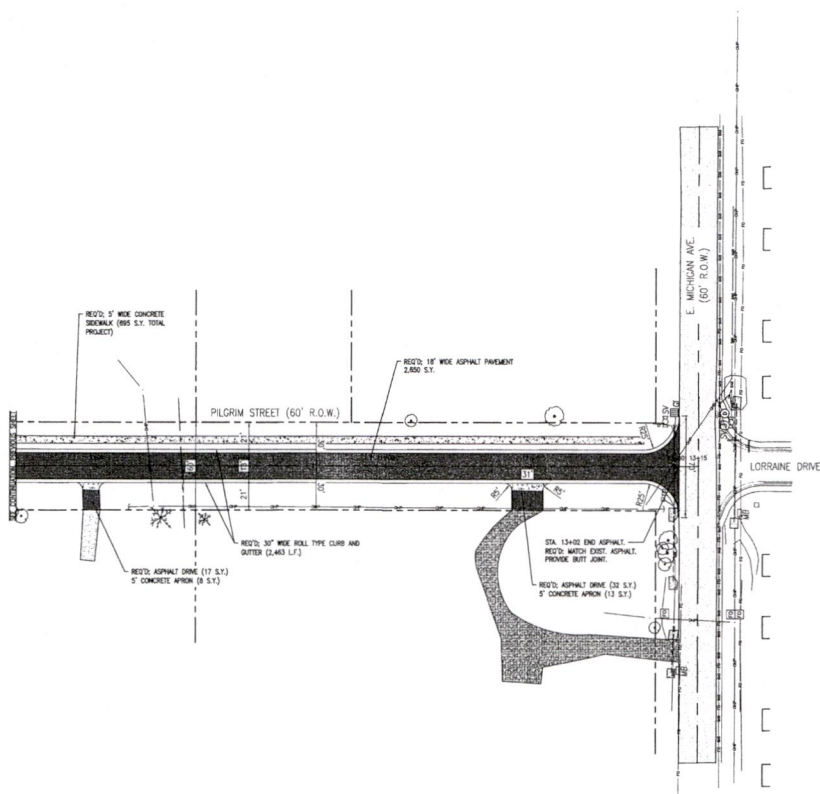

LEGEND

Δ CTF	CRIMPED TOP IRON FOUND	\square GI	GRATE INLET
RBF Δ	IRON PIPE FOUND	MB	MAIL BOX
LP	REDIR. IRON FOUND	FB	FIBER MARKER
FP	LIGHT POLE	TP	TELEPHONE PEDESTAL
WM	FIRE HYDRANT	①	GRASS INLET
WM	WATER METER	---	OVERHEAD ELECTRIC
SV	SEWER MANHOLE	---	EXISTING GAS
SV	SEWER VALVE	---	EXISTING FIBER OPTICS
		---	EXISTING SANITARY SEWER
		---	RIGHT OF WAY

NUMBER	REVISION	DATE



Pillar

GEOMETRY PLAN 3
PILGRIM STREET
CITY OF FOLEY



SCALE	1"=30'
DATE	JANUARY, 2025
DRAWN BY	
CHECKED BY	
SHEET	08 OF 19

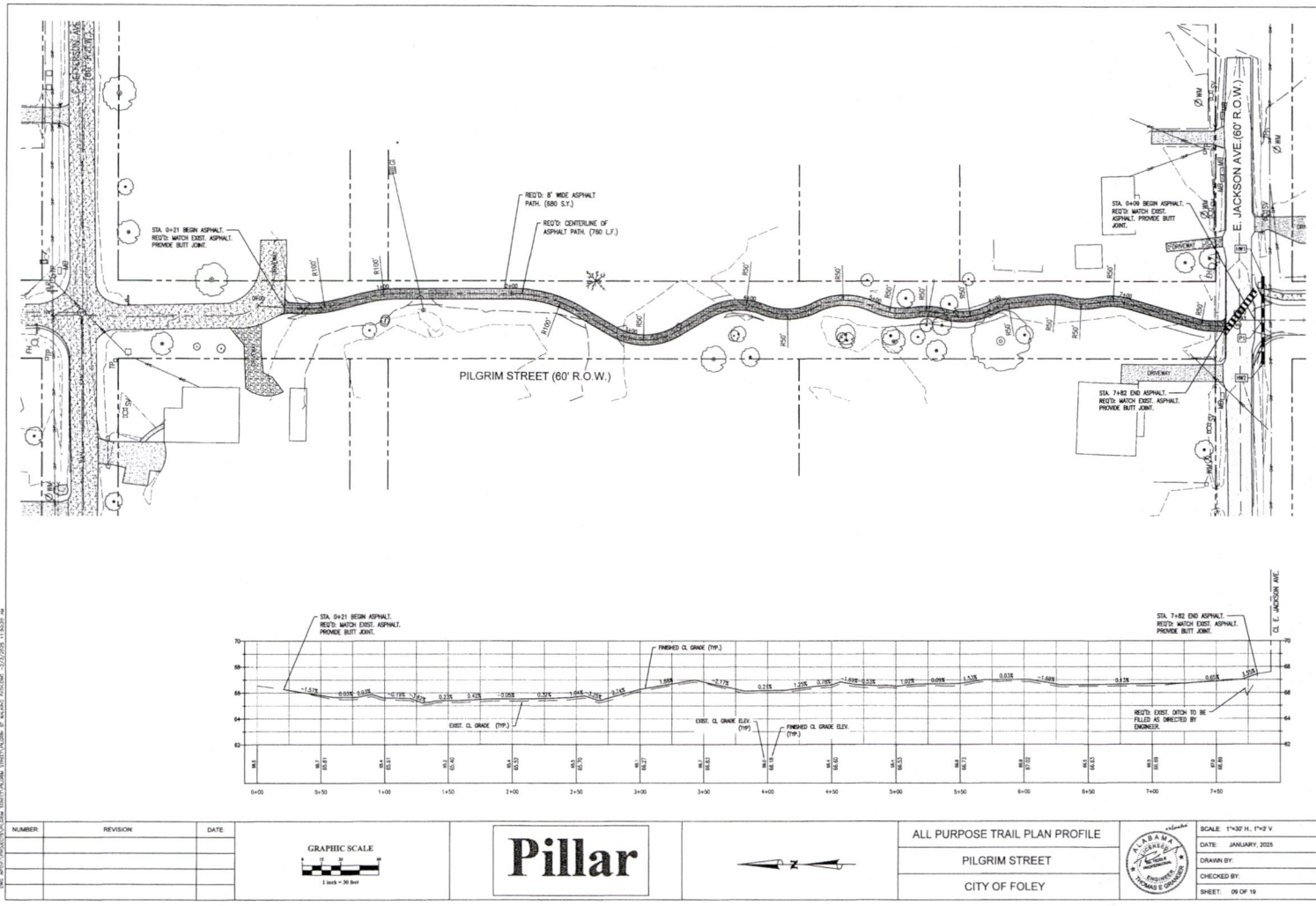

NUMBER	REVISION	DATE

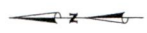

ALL PURPOSE TRAIL PLAN PROFILE
PILGRIM STREET
CITY OF FOLEY



SCALE: 1"=30' H., 1"=3' V.
DATE: JANUARY, 2025
DRAWN BY:
CHECKED BY:
SHEET: 09 OF 19

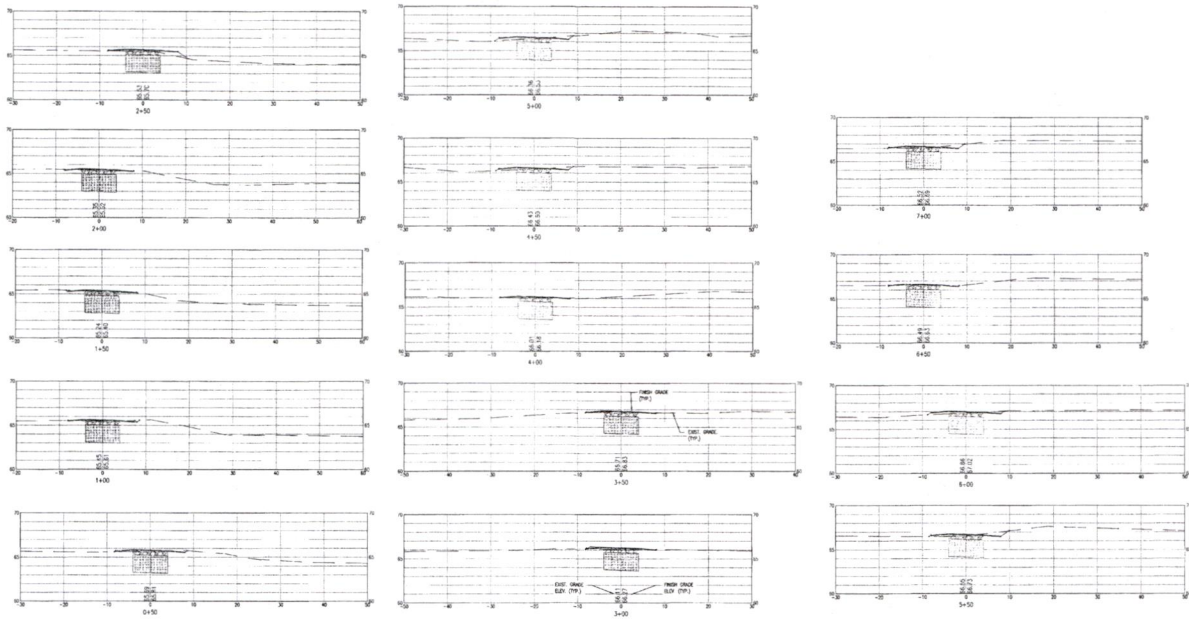

NUMBER	REVISION	DATE

Pillar

CROSS SECTIONS ALL PURPOSE TRAIL
 PILGRIM STREET
 CITY OF FOLEY



NOTE: SEE SHT. 14 FOR
 TYPICAL PAVEMENT SECTION.
 SCALE: 1"=10' H, 1"=10' V
 DATE: JANUARY, 2025
 DRAWN BY:
 CHECKED BY:
 SHEET: 11 OF 19

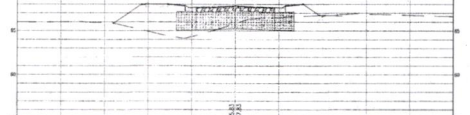
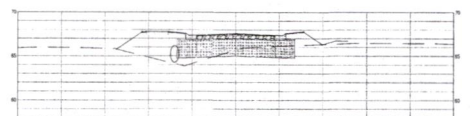
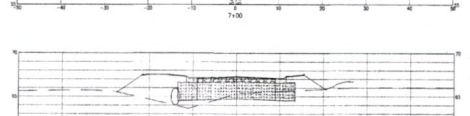
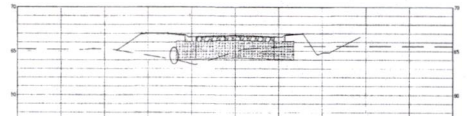
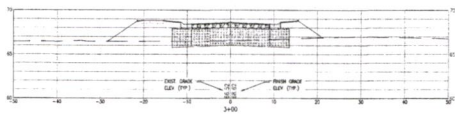
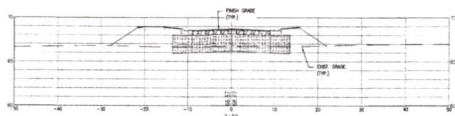
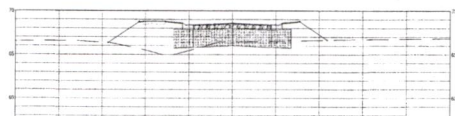
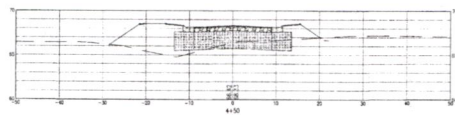
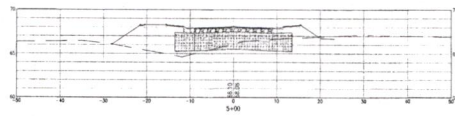
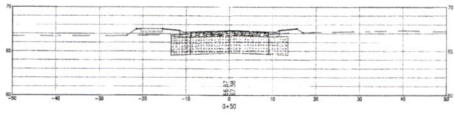
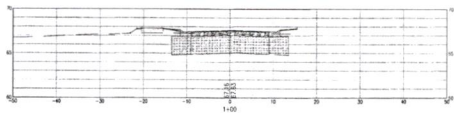
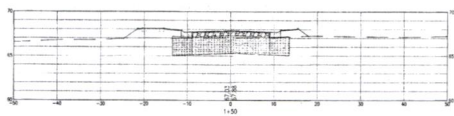
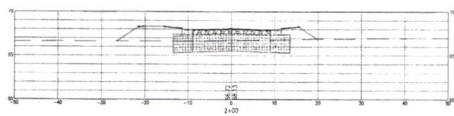
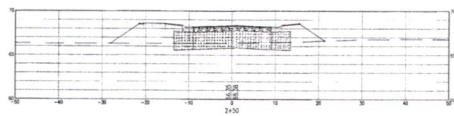

NUMBER	REVISION	DATE

Pillar

CROSS SECTIONS
PILGRIM STREET
CITY OF FOLEY



NOTE: SEE SH. 14 FOR
TYPICAL PAVEMENT SECTION.
SCALE: 1"=10' H. 1"=10' V.
DATE: JANUARY, 2025
DRAWN BY:
CHECKED BY:
SHEET: 12 OF 19

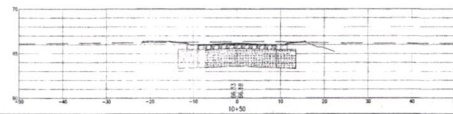
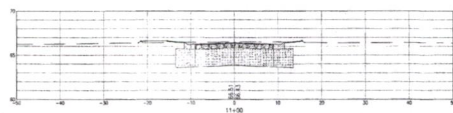
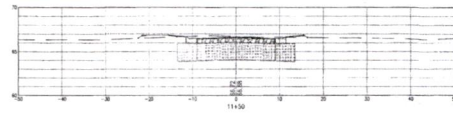
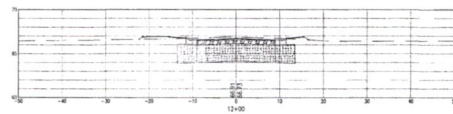
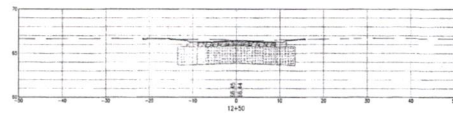
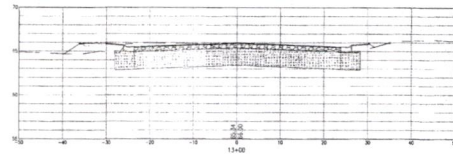
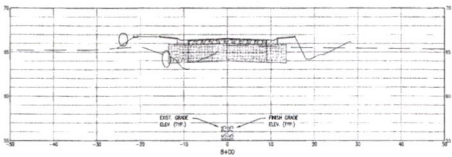
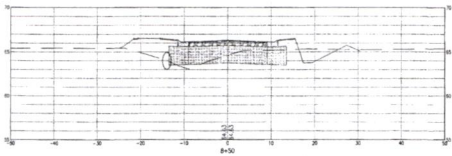
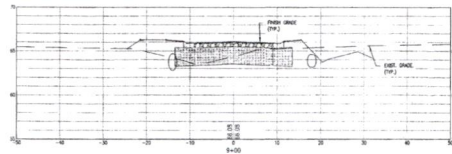
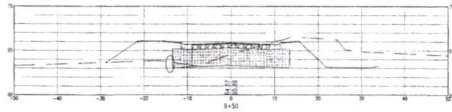
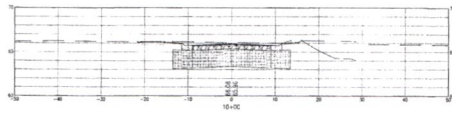

NOTE: SEE SHT. 14 FOR
TYPICAL PAVEMENT SECTION.

Pillar

CROSS SECTIONS
PILGRIM STREET
CITY OF FOLEY



SCALE: 1"=10' H. 1"=8' V.
DATE: JANUARY, 2025
DRAWN BY:
CHECKED BY:
SHEET: 13 OF 18

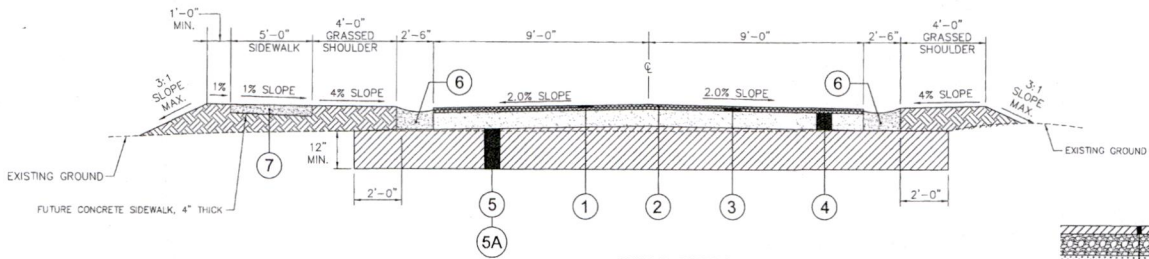

TYPICAL SECTION
N.T.S.

- ① ITEM 424-A, 1-1/4" SUPERPAVE BITUMINOUS CONCRETE WEARING SURFACE LAYER, 1/2" MAXIMUM AGGREGATE SIZE MIX, ESAL RANGE B, 138 LB/SY
- ② ITEM 405, TACK COAT
- ③ ITEM 424-B, 1-1/2" BITUMINOUS BINDER LAYER (165 LB/SY)
- ④ ITEM 301-A, CRUSHED AGGREGATE BASE COURSE, 6" COMPACTED THICKNESS, (ALDOT SECTION 821)
- ⑤ ITEM 210-A, UNCLASSIFIED EXCAVATION, MIN. 1'-8" DEEP BELOW LOWER BASE COURSE
- ⑤A ITEM 210-D, BORROW EXCAVATION, SELECT FILL A-2-4 MATERIAL WITH LESS THAN 12% PASSING NO. 200 SIEVE, LOWER LIFT MINIMUM 12" THICK, COMPACTED TO 95% STANDARD PROCTOR DENSITY. UPPER LIFT MAXIMUM 8" THICK, COMPACTED TO 100% ASTM D-698 STANDARD DENSITY.
- ⑥ 623-A CONCRETE CURB & GUTTER, R-3 ROLL TYPE CURB (30")
- ⑦ 618-A CONCRETE SIDEWALK, 4" THICK.

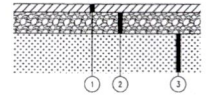

NEW ASPHALT DRIVEWAY SECTION
N.T.S.

1. 1-1/2" ALDOT SECTION 424B BITUMINOUS BINDER (165 LB/SY)
2. 8" ALDOT SECTION 821, CRUSHED AGGREGATE BASE COURSE, (COMPACTED TO 100% MAX. DENSITY)
3. COMPACT NATIVE SUBGRADE OR STRUCTURAL FILL (TOP 12" COMPACTED TO 100% STANDARD DENSITY)

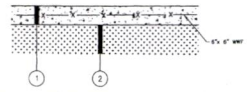

CONCRETE DRIVEWAY APRON SECTION
N.T.S.

1. 8" CONCRETE PAVEMENT (4,000 PSI COMPRESSIVE STRENGTH, 450 PSI FLEXURAL STRENGTH)
2. COMPACT NATIVE SUBGRADE OR STRUCTURAL FILL (TOP 12" COMPACTED TO 100% STANDARD DENSITY)



CONCRETE SIDEWALK
N.T.S.

NOTE: CONTROL JOINTS NEED DEPTH 4".
EXCAVATION JOINTS NEED DEPTH 2".

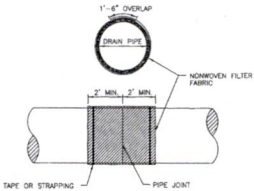

PIPE JOINT WRAP
N.T.S.

SUPERPAVE BITUMINOUS CONCRETE WEARING SURFACE (424A-340)
1/1" MAXIMUM AGGREGATE SIZE MIX, ESAL RANGE A/B (APPROX. 220# / SY)

CRUSHED AGGREGATE BASE COURSE, TYPE B, PLANT MIXED

BORROW EXCAVATION-IMPORTED COMPACTED GRANULAR FILL
MEETING ADOPTED A-2-4 (N) CLASSIFICATION OR BETTER

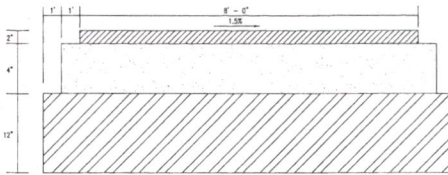

LIGHT DUTY PAVING (ALL PURPOSE TRAIL)
N.T.S.

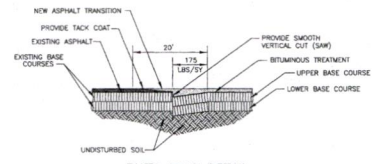

BUTT JOINT DETAIL
N.T.S.

NUMBER	REVISION	DATE

Pillar

CIVIL CONSTRUCTION DETAILS

PILGRIM STREET

CITY OF FOLEY



SCALE: N.T.S.
DATE: JANUARY, 2025
DRAWN BY: T.G.
CHECKED BY: T.G.
SHEET: 14 OF 18

NUMBER	REVISION	DATE	<div>Pillar</div>	CIVIL CONSTRUCTION DETAILS 2	<div><div><div>Professional Engineer THOMAS E O'CONNELL No. 24-000879 State of New Jersey</div><div>Seal</div></div><div>SCALE: N.T.S. DATE: JANUARY, 2025 DRAWN BY: CHECKED BY: T.G. SHEET: 15 OF 19</div></div>
				PILGRIM STREET	
				CITY OF FOLEY	

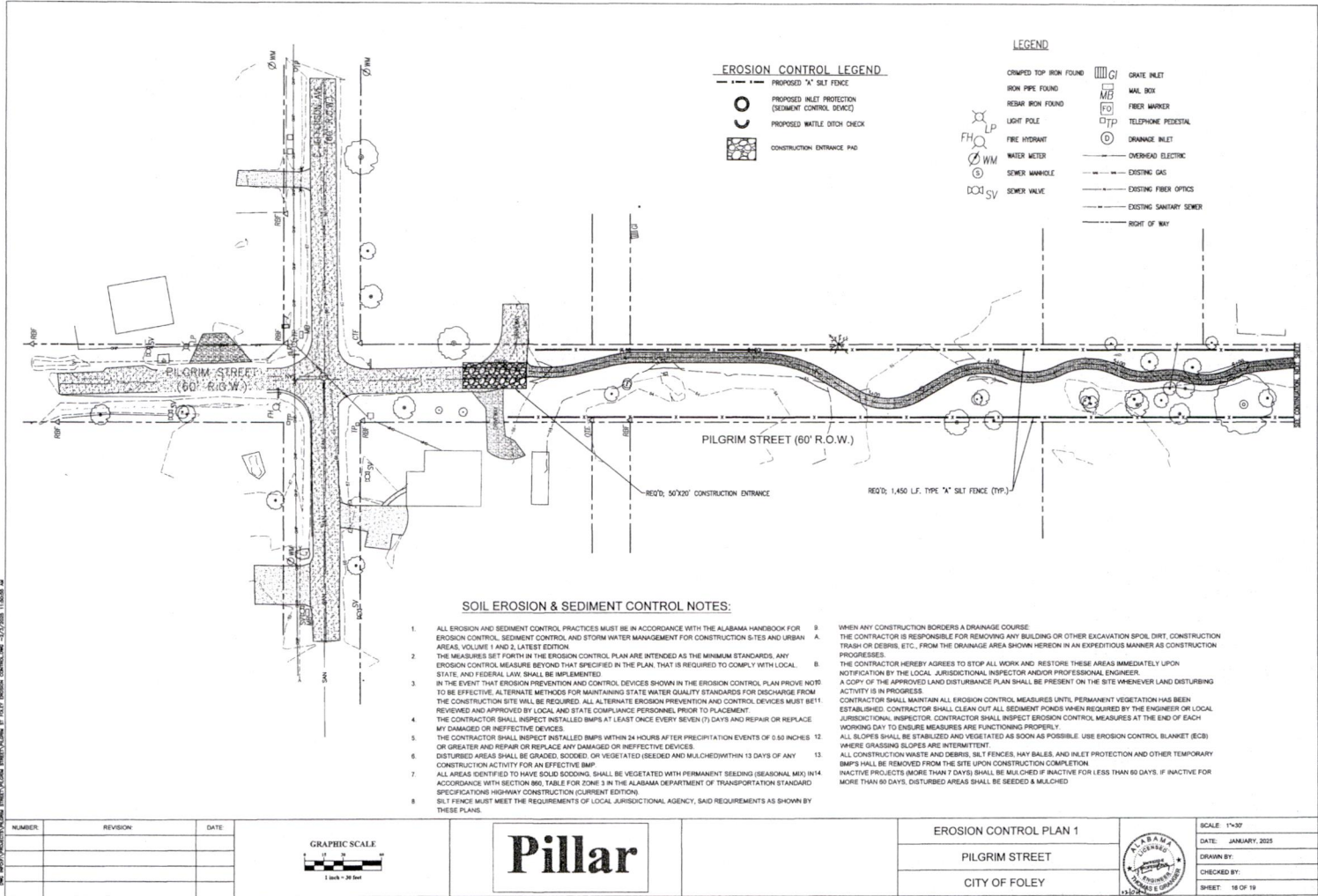

SOIL EROSION & SEDIMENT CONTROL NOTES:

1. ALL EROSION AND SEDIMENT CONTROL PRACTICES MUST BE IN ACCORDANCE WITH THE ALABAMA HANDBOOK FOR EROSION CONTROL, SEDIMENT CONTROL, AND STORM WATER MANAGEMENT FOR CONSTRUCTION SITES AND URBAN AREAS, VOLUME 1 AND 2, LATEST EDITION.
2. THE MEASURES SET FORTH IN THE EROSION CONTROL PLAN ARE INTENDED AS THE MINIMUM STANDARDS. ANY EROSION CONTROL MEASURE BEYOND THAT SPECIFIED IN THE PLAN, THAT IS REQUIRED TO COMPLY WITH LOCAL, STATE, AND FEDERAL LAW, SHALL BE IMPLEMENTED.
3. IN THE EVENT THAT EROSION PREVENTION AND CONTROL DEVICES SHOWN IN THE EROSION CONTROL PLAN PROVE NOT TO BE EFFECTIVE, ALTERNATE METHODS FOR MAINTAINING STATE WATER QUALITY STANDARDS FOR DISCHARGE FROM THE CONSTRUCTION SITE WILL BE REQUIRED. ALL ALTERNATE EROSION PREVENTION AND CONTROL DEVICES MUST BE REVIEWED AND APPROVED BY LOCAL AND STATE COMPLIANCE PERSONNEL PRIOR TO PLACEMENT.
4. THE CONTRACTOR SHALL INSPECT INSTALLED BMPs AT LEAST ONCE EVERY SEVEN (7) DAYS AND REPAIR OR REPLACE ANY DAMAGED OR INEFFECTIVE DEVICES.
5. THE CONTRACTOR SHALL INSPECT INSTALLED BMPs WITHIN 24 HOURS AFTER PRECIPITATION EVENTS OF 0.50 INCHES OR GREATER AND REPAIR OR REPLACE ANY DAMAGED OR INEFFECTIVE DEVICES.
6. DISTURBED AREAS SHALL BE GRADED, SOODED, OR VEGETATED (SEEDING AND MULCHING) WITHIN 13 DAYS OF ANY CONSTRUCTION ACTIVITY FOR AN EFFECTIVE BMP.
7. ALL AREAS IDENTIFIED TO HAVE SOID SOODING, SHALL BE VEGETATED WITH PERMANENT SEEDING (SEASONAL MIX) IN ACCORDANCE WITH SECTION 802, TABLE FOR ZONE 3 IN THE ALABAMA DEPARTMENT OF TRANSPORTATION STANDARD SPECIFICATIONS HIGHWAY CONSTRUCTION (CURRENT EDITION).
8. SILT FENCE MUST MEET THE REQUIREMENTS OF LOCAL JURISDICTIONAL AGENCY, SAID REQUIREMENTS AS SHOWN BY THESE PLANS.

WHEN ANY CONSTRUCTION BORDERS A DRAINAGE COURSE THE CONTRACTOR IS RESPONSIBLE FOR REMOVING ANY BUILDING OR OTHER EXCAVATION SPOIL DIRT, CONSTRUCTION TRASH OR DEBRIS, ETC., FROM THE DRAINAGE AREA SHOWN HEREON IN AN EXPEDITIOUS MANNER AS CONSTRUCTION PROGRESSES.

THE CONTRACTOR HEREBY AGREES TO STOP ALL WORK AND RESTORE THESE AREAS IMMEDIATELY UPON NOTIFICATION BY THE LOCAL JURISDICTIONAL INSPECTOR AND/OR PROFESSIONAL ENGINEER.

A COPY OF THE APPROVED LAND DISTURBANCE PLAN SHALL BE PRESENT ON THE SITE WHENEVER LAND DISTURBING ACTIVITY IS IN PROGRESS.

CONTRACTOR SHALL MAINTAIN ALL EROSION CONTROL MEASURES UNTIL PERMANENT VEGETATION HAS BEEN ESTABLISHED. CONTRACTOR SHALL CLEAN OUT ALL SEDIMENT POND WHEN REQUIRED BY THE ENGINEER OR LOCAL JURISDICTIONAL INSPECTOR. CONTRACTOR SHALL INSPECT EROSION CONTROL MEASURES AT THE END OF EACH WORKING DAY TO ENSURE MEASURES ARE FUNCTIONING PROPERLY.

ALL SLOPES SHALL BE STABILIZED AND VEGETATED AS SOON AS POSSIBLE. USE EROSION CONTROL BLANKET (ECB) WHERE GRASSING SLOPES ARE INTERMITTENT.

ALL CONSTRUCTION WASTE AND DEBRIS, SILT FENCES, HAY BALES, AND INLET PROTECTION AND OTHER TEMPORARY BMPs SHALL BE REMOVED FROM THE SITE UPON CONSTRUCTION COMPLETION.

INACTIVE PROJECTS (MORE THAN 7 DAYS) SHALL BE MULCHED IF INACTIVE FOR LESS THAN 60 DAYS. IF INACTIVE FOR MORE THAN 90 DAYS, DISTURBED AREAS SHALL BE SEEDDED & MULCHED.

NUMBER	REVISION	DATE



Pillar

EROSION CONTROL PLAN 1
PILGRIM STREET
CITY OF FOLEY



SCALE: 1"=20'
DATE: JANUARY, 2023
DRAWN BY:
CHECKED BY:
SHEET: 18 OF 19

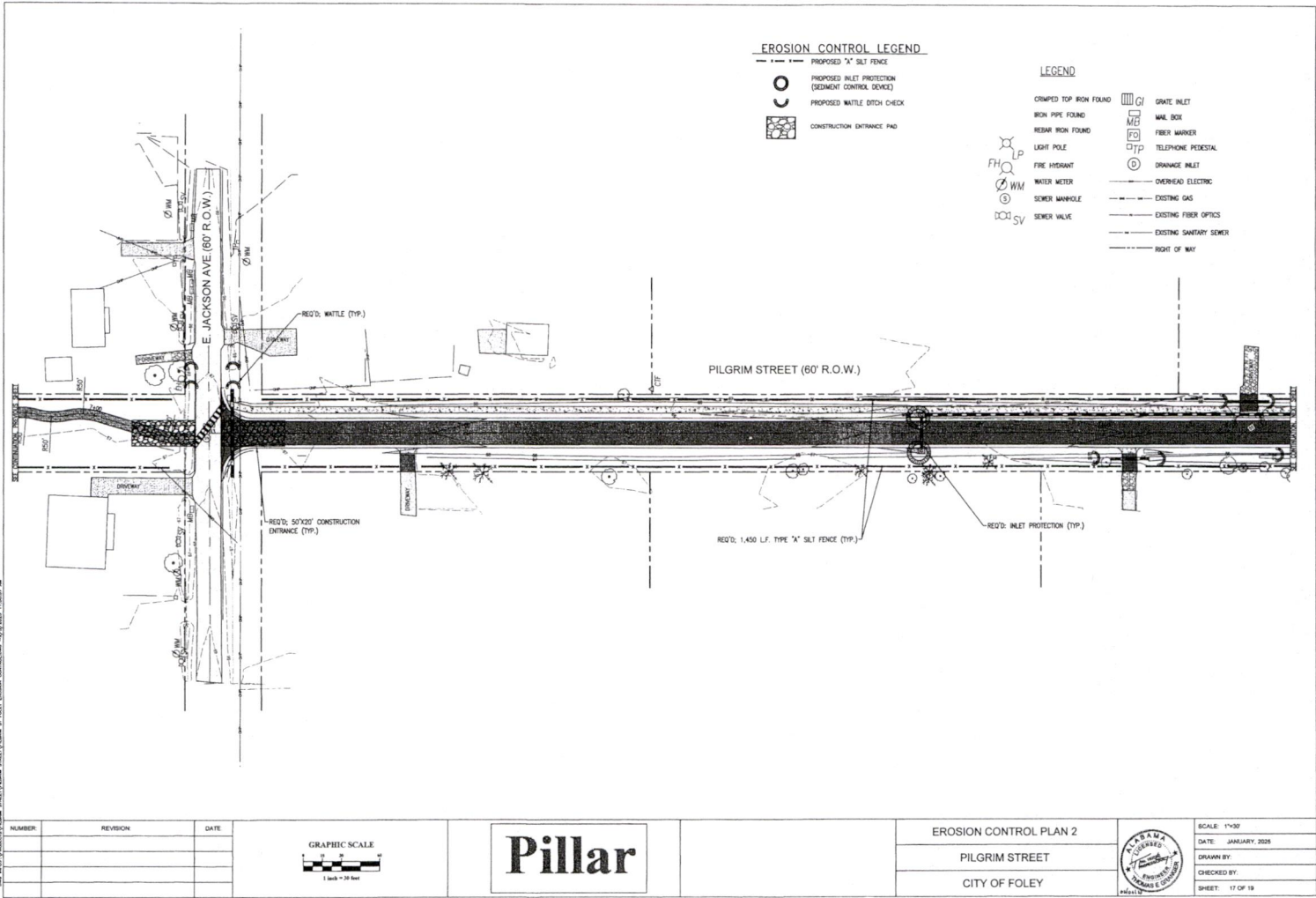

EROSION CONTROL LEGEND

- PROPOSED 1" SALT FENCE
- PROPOSED INLET PROTECTION (SEDIMENT CONTROL DEVICE)
- PROPOSED WATTLE BENCH CHECK
- CONSTRUCTION ENTRANCE PAD

LEGEND

- CRIMPED TOP IRON FOUND
- IRON PIPE FOUND
- REBAR IRON FOUND
- LIGHT POLE
- FIRE HYDRANT
- WATER METER
- SEWER MANHOLE
- SEWER VALVE
- GRATE INLET
- WALL BOX
- FIBER MARKER
- TELEPHONE PEDISTAL
- DRAINAGE INLET
- OVERHEAD ELECTRIC
- EXISTING GAS
- EXISTING FIBER OPTICS
- EXISTING SANITARY SEWER
- RIGHT OF WAY

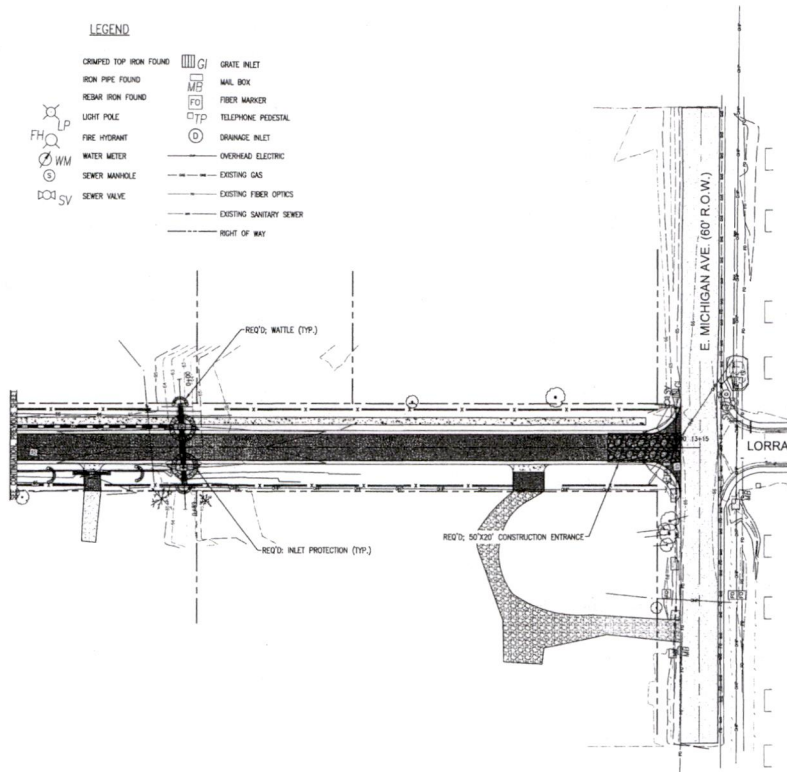

Pillar

EROSION CONTROL PLAN 3

PILGRIM STREET

CITY OF FOLEY



SCALE: 1"=30'
DATE: JANUARY, 2025
DRAWN BY:
CHECKED BY:
SHEET: 18 OF 19

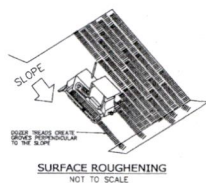

SURFACE ROUGHENING
NOT TO SCALE

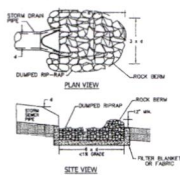

RIPRAP OUTLET PROTECTION
NOT TO SCALE

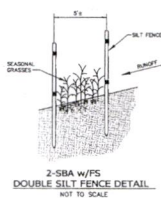

DOUBLE SILT FENCE DETAIL
NOT TO SCALE

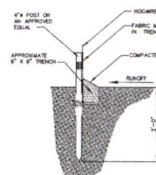

SECTION

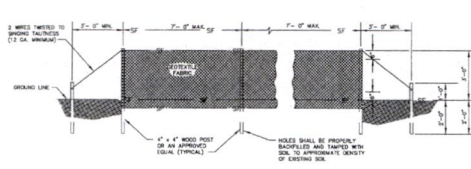

TYPE "A" TYPICAL SILT FENCE INSTALLATION
NOT TO SCALE

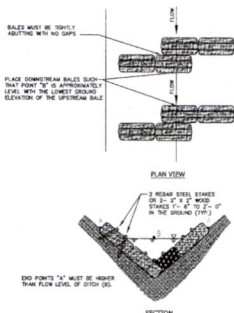

TYPICAL STRAW BALE INSTALLATION
NOT TO SCALE

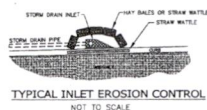
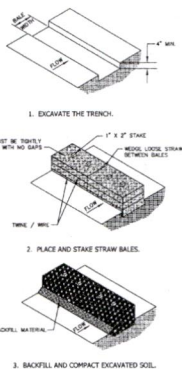

TYPICAL INLET EROSION CONTROL
NOT TO SCALE

GENERAL NOTES

1. TYPE "A" SILT FENCE SHALL BE USED IN AREAS OF CONCENTRATED FLOW.
2. SILT FENCES USE TEMPORARY EROSION CONTROL TREATMENT THAT SHALL BE REMOVED APPROPRIATE DRAINAGE AREAS SUCH AS NEWLY GRADED FULL SLOPES AND ADJACENT TO STREAMS AND CHANNELS.
3. SILT FENCE SHOULD BE PLACED WELL BEHIND PROPERTY BOUNDARY AND ALONG EDGE OF CLEARING/PAVING THIS WILL ALLOW ROOM FOR A BACK-UP FENCE IF FIRST BECOMES FULL. SILT FENCES SHALL BE IN PLACE PRIOR TO ANY CONSTRUCTION OPERATION.
4. WHENEVER POSSIBLE, SILT FENCES SHALL BE CONSTRUCTED ACROSS A FLOW AREA BY THE SHARP OF A HORIZONAL THIS AID IN PREVENTING OF RUNOFF AND FACILITATES SEDIMENTATION.
5. AFTER THE CONSTRUCTION AREA IS STABILIZED AND EROSION ACTIVITY CEASED, SILT FENCES SHALL BE REMOVED.
6. WHEN FACTORS USED TO SECURE GEOTEXTILES TO WOODEN WIRE TO POSTS SHALL BE USED. STAPLES FOR SECURING WIRE TO POSTS SHALL BE USED. STAPLES SHALL BE 1 1/2\"/>

SPECIFICATIONS

CURRENT ALABAMA DEPARTMENT OF TRANSPORTATION

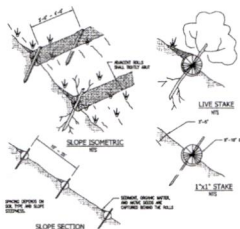

STRAW WATTLES

SLOPE PROTECTING INSTALLATION DETAIL

NOT TO SCALE

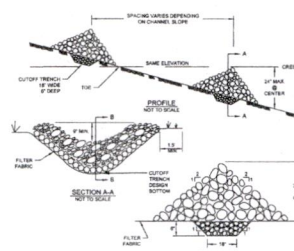

CHECK DAM DETAILS
NOT TO SCALE

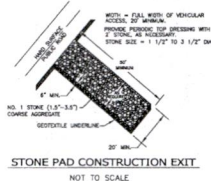

STONE PAD CONSTRUCTION EXIT
NOT TO SCALE

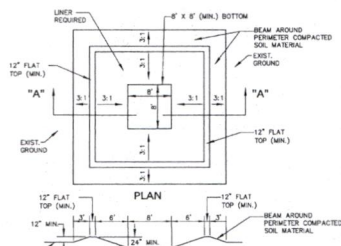

CONCRETE WASHOUT STRUCTURE
NOT TO SCALE

NUMBER	REVISION	DATE

Pillar

EROSION CONTROL DETAILS
PILGRIM STREET
CITY OF FOLEY



SCALE: N.T.S.
DATE: JANUARY, 2028
DRAWN BY:
CHECKED BY: T.G.
SHEET: 19 OF 19

Cost Estimate

City of Foley
Pilgrim Street Extension

E. Jackson to E.
Michigan
Road Extension

January 2025

ITEM #	DESCRIPTION	UNIT	QTY	UNIT PRICE	AMOUNT
206-C1	REMOVAL OF CONCRETE	SY	64	\$7.00	\$ 448.00
206-E1	REMOVAL OF DRAINAGE STRUCTURE	EA	1	\$800.00	\$ 800.00
210-A1	UNCLASSIFIED EXCAVATION	CY	3,950	\$11.50	\$ 45,425.00
210-D	BORROW EXCAVATION,STRUCTURAL FILL (1'-8" MIN.) (A-2-4)	CY	3,163	\$25.00	\$ 79,075.00
301-A1	AGGREGATE BASE COURSE, TYPE B, 6" THICK	SY	3,350	\$30.00	\$ 100,500.00
424-A	1-1/4", SUPERPAVE BITUMINOUS CONCRETE WEARING SURFACE, 1/2" MAX. AGGREGATE SIZE MIX, ESAL RANGE B, 138 LB/SY	TONS	200	\$145.00	\$ 29,000.00
424-C	1-1/2" BITUMINOUS BINDER LAYER (165 LB/SY)	TONS	220	\$155.00	\$ 34,100.00
623-A	CONCRETE DRIVEWAY APRON 6" THICK	SY	46		
623-A	CONCRETE CURB & GUTTER, R-3 ROLL TYPE CURB (30")	LF	2,463	\$48.00	\$ 118,224.00
618-A	5' WIDE CONCRETE SIDEWALK	SY	695	\$85.00	\$ 59,075.00
533-B1	18" RCP STORM DRAIN	LF	429	\$85.00	\$ 36,465.00
533-B2	18" X 11" RCAP STORM DRAIN	LF	89	\$75.00	\$ 6,675.00
533-B3	22" X 14" RCAP STORM DRAIN	LF	68	\$85.00	\$ 5,780.00
533-B4	36"X22" RCAP STORM DRAIN	LF	58	\$115.00	\$ 6,670.00
619-A	CONCRETE SLOPE PAVED HEADWALL	EA	10	\$1,200.00	\$ 12,000.00
600-A	MOBILIZATION	LS	1	\$20,000.00	\$ 20,000.00
206-D1	REMOVAL OF PIPE	LF	100	\$15.00	\$ 1,500.00

405	TACK COAT	SY	2,650	\$2.00	\$ 5,300.00
206-A	SAWCUT EXISTING ASPHALT	LF	140	\$8.00	\$ 1,120.00
660-D	REMOVAL OF TREES	EA	14	\$2,500.00	\$ 35,000.00
660-E	EXISTING GRAVEL REMOVAL	SY	800	\$12.00	\$ 9,600.00
660-F	EXISTING RIP RAP REMOVAL	SY	8	\$100.00	\$ 800.00
665-J	SILT FENCE, TYPE "A"	LF	2,350	\$6.50	\$ 15,275.00
665-I	INLET PROTECTION DEVICES	EA	4	\$65.00	\$ 260.00
665-Q	WATTLES	EA	4	\$75.00	\$ 300.00
665-R	50'X20' CONSTRUCTION ENTRANCE	EA	2	\$2,500.00	\$ 5,000.00
621-A	DOUBLE "S" INLET	EA	2	\$7,500.00	\$ 15,000.00
621-B	SINGLE "S" INLET	EA	2	\$5,000.00	\$ 10,000.00
252-A	SEEDING/MULCHING	AC	1.0	\$2,750.00	\$ 2,750.00
654-A	SOLID SODDING	SY	900	\$7.00	\$ 6,300.00
650-A	TOP SOIL	CY	260	\$42.00	\$ 10,920.00
999-X	WORK OF SIMILAR NATURE	LS	1	\$15,000.00	\$ 15,000.00
TOTAL					\$ 688,362.00

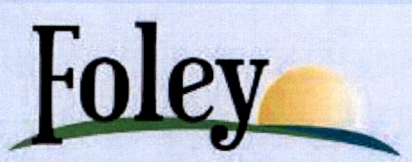

Thursday, February 6, 2025

CAPITAL ITEM BUDGET FORM

Submitted by:

Chad Raybon

Date

02/06/2025

Department

Street Department

Email

craybon@cityoffoley.org

Select item type

Capital Project

Item Listed in Budget

Capital Project Plan

Capital item description

Pilgrim Extension

Will this capital item replace a current capital asset?

No

Is there a Grant associated with this capital item?

No

CAPITAL PURCHASE/PROJECT EXPENDITURE

Budget Information

Budgeted Capital Purchase: Approved and funds are appropriated by the City Council as part of the adoption of the Current Fiscal Year Budget.

Planned Capital Purchase: Included in the 10-Year Capital Purchases Plan within the Current Fiscal Year Budget, but funds are not appropriated at the time of budget adoption.

Capital Project: Included in the 10-Year Capital Projects Plan within the Current Fiscal Year Budget, but funds are not appropriated at the time of budget adoption.

The approved current fiscal year budget shows the capital item expenditure is budgeted/planned in fiscal year(s) (1) 2024 and/or (2) 2025 .

Please Select

Please Select

Planned Project Amount (1)	\$350,000
Planned Project Amount (2)	\$0
Planned Project Total (1+2)	\$350,000
Planned Grant Amount	\$0
Projected Cost/Expenditure	\$600,000
Excess/(Deficiency)	\$-250,000

Funding Information

Appropriated Amount	\$0
Approved Grant Amount	\$0
Projected Cost/Expenditure	\$600,000
Excess(Deficient) Funds	\$-600,000

Explanation for deficient funds or other important information:

The Pilgrim extensions plans include a multi-use purpose path with lighting and sidewalks added.

Request the following budget impact:

Increase Budget by APPROPRIATING Funds

Budget Category appropriating funds to:

Capital Project

Budget Appropriation Detail:

Amount of Funds	Account Number	Account Name
600000	400-3010-5100	City Constructed Roads

Explanation for budget appropriation and/or transfer:

Road expected to cost less than estimated by Pillar, due to project crew doing in house work. The overall price increase of the road is due to the multi-use path, lighting, sidewalks, and equipment rental.

Approval Activity History

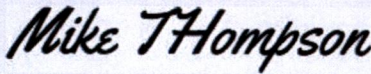
Actor	Actions	Date
mthompson@cityoffoley.org	<div>Approve</div> 	Thursday, February 6, 2025
Notification	<p>Approve & Sign request sent to group approval: Require response from one person To: wtrawick@trawickb.com, trawickb@gulftel.com, wtrawick@cityoffoley.org</p>	Thursday, February 6, 2025
wtrawick@trawickb.com	<div>Approve</div>  wtrawick@trawickb.com's signature  Approve & Sign	Thursday, February 6, 2025
Group Approval	<div>Approve</div>	Thursday, February 6, 2025
Notification	<p>Email sent. (Your request has been approved.) craybon@cityoffoley.org</p>	Thursday, February 6, 2025



PILGRIM ST COST ESTIMATE 2.pdf

INVOICE

Pillar

DATE

02/07/2025

INVOICE NO

City of Foley - 007

144525 State Hwy 181
Fairhope, AL 36532
(251) 295-6921
Pillarteg64@gmail.com

INVOICE TO

City of Foley
Attn: Chad Christian, PE
City Engineer
200 West Laurel Ave.
Foley, AL 36535

SALESPERSON	JOB	PAYMENT TERMS	DUE DATE
Thomas E. Granger	Pilgrim St. Design E. Jackson to E Jefferson All Purpose Trail 24-1081RES	Upon Receipt	

QUANTITY	DESCRIPTION	UNIT PRICE	LINE TOTAL
----------	-------------	------------	------------

Note: This is for the additional Design Services to change from a roadway to an "All Purpose Trail" after the road design had been completed. This work was approved verbally by Mr. Wayne Dyess.

LS	Design Engineering	\$2,200.00	\$2,200.00
----	--------------------	------------	------------

Subtotal	\$2,200.00
Total	\$2,200.00