

COMPLAINT FORM:

CITIZEN COMPLETE THIS PORTION:

DATE: 4-5-16

NAME/EMAIL/CONTACT INFORMATION: Leslie

LOCATION/ADDRESS OF COMPLAINT: 1817 Candlestick Ct E

TYPE OF COMPLAINT: grass & weeds overgrown

TO BE COMPLETED BY STAFF:

INCIDENT #: 89805

PIN #: 113270

ZONING/HISTORIC/OVERLAY DISTRICT: R-2

ROUTE TO: BUILDING: ZONING: ENVIRONMENTAL: ☒

TO BE COMPLETED BY DIVISION/INSPECTOR:

INSPECTED BY: JAH DATE: 5/9/16

FINDINGS/REPORT: The yard is overgrown with grass weeds.

Letter mailed. Reinspect property 5/25/16. JAH
5/26/16 property is still overgrown. Council level. JAH

ACTION: PERSONAL CONTACT: LETTER: ☒ STOP WORK: CITATION: NO VIOLATION:

DATE CLOSED: 5/26/16



Baldwin County Revenue Commissioner

Property Link BALDWIN COUNTY, AL

Tax Year 2015

Current Date 5/10/2016

Valuation Date October 1, 2014

Records Last Updated 5/ 9/2016

PROPERTY DETAIL

OWNER EHRIE, DENA S
1817 CANDLESTICK CT E

ACRES : **NA**

FOLEY, AL 36535

APPRAISED VALUE: 76600

ASSESSED : 7660

PARCEL 54-04-17-4-000-012.045

ADDRESS 1817 CANDLESTICK CT E

TAX INFORMATION

YEAR 2015	TAX DUE	PAID	BALANCE
	207.78	207.78	0.00

LAST PAYMENT DATE 11 / 28 / 2015

MISCELLANEOUS INFORMATION

EXEMPT CODES H1 **DESCRIPTION** 39.35'X164.11'IRR LOT 32 CANDL
ESTICK ESTATES PHASE 2 SLIDE

TAX DISTRICT 07 1388-A SEC 17-T7S-R4E

PPIN 113270 Entry 00

ESCAPE YEAR

ACCOUNT NUMBER 044034

TAX HISTORY

Year	Owner	Total Tax	Paid(Y/N)	Appraised	Assessed
2014	EHRIE, DENA S	192.60	Y 12/ 6/2014	71900	7200
2013	EHRIE, DENA S	183.36	Y 12/ 7/2013	69000	6920
2012	EHRIE, DENA S	187.98	Y 12/22/2012	70500	7060
2011	EHRIE, DENA S	175.44	Y 12/10/2011	66800	6680
2010	EHRIE, DENA S	199.20	Y 12/31/2010	73900	7400
2009	EHRIE, DENA S	240.78	Y 12/ 5/2009	86500	8660
2008	EHRIE, DENA S	245.40	Y 1/26/2009	88000	8800
2007	EHRIE, DENA S	222.30	Y 12/31/2007	80800	8100
2006	EHRIE, DENA S	184.02	Y 2/20/2007	69300	6940

TAX SALES

PURCHASE COUNTY TAX SALE FILES

Year Sold To Redeemed Date/By

NO TAX SALES FOUND



Overview

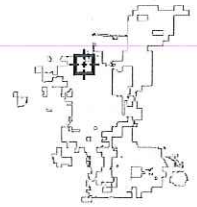

Legend

-  Main Highways
-  County Roads
-  Centerlines
-  Foley City Limits
-  County Mask
-  Foley City Limit Background
-  Parcels
-  Lot Lines
-  Streams and Creel
-  Lakes and Bays

PIN - 113270
 Par Num - 012.045
 Acreage - 0.279
 Subdivision - 01CS2
 Lot -
 Street Name - CANDLESTICK CTE
 Street Number - 1817
 Improvement - RES

Name - EHRIE, DENAS
 Address1 - 1817 CANDLESTICK CTE
 Address2 -
 Address3 -
 City - FOLEY
 State - AL
 Zip - 36535

The information contained in the digital data distributed by the Baldwin County Commission is derived from a variety of public and private sources considered to be dependable, but the accuracy, completeness, currency, thereof are not guaranteed. The Baldwin County Commission makes no warranties, expressed or implied, as to the accuracy, completeness, currency, reliability, or suitability for any particular purpose of information or data contained in or generated from the county geographic database. Additionally, the Baldwin County Commission or any agent, servant, or employee thereof assume no liability associated with the use of the data and assume no responsibility to maintain it in any matter or form.

Date created: 5/10/2016

5.10.16

1816 E Candlestick Ct grass/weeds

JAT







City of

FOLEY

COMMUNITY DEVELOPMENT DEPARTMENT

200 NORTH ALSTON STREET

Foley, Alabama 36535

www.cityoffoley.org

(251) 952-4011

FAX (251) 971-3442

May 10, 2016

Dena Ehrie
1817 Candlestick CT E
Foley, AL 36535

Dear Madam:

A complaint has been received concerning the overgrown grass and weeds becoming a public nuisance at 1817 Candlestick Court E in Foley, Alabama. This lot is further described as PIN 113270 on the Baldwin County Tax Maps.

The City of Foley Ordinance No. 1095-09 Regarding the Clearing and Maintenance of Lots that Constitute a Public Nuisance Section 4-104 states that a nuisance may be declared when grass and weeds which bear seeds of a wingy or downy nature, which attain a large growth so as to become a fire menace when dry, or otherwise noxious or dangerous. Private property owners should take regular steps to maintain the property in a manner to prevent the nuisance.

A visual inspection, conducted on May 10, 2016 revealed that the above described property was overgrown by grass and weeds which may constitute a public nuisance. Please be advised that as of this date you are placed on notice that this violation must be corrected within 10 days from your receipt of this letter. Failure to do so may result in a Resolution by the City Council that finds and declares that the weeds, grass and other vegetation are a public nuisance and orders the abatement of the nuisance subject to its findings after a public hearing.

If you have any questions or concerns please contact our office at 251-952-4011.

Sincerely,

Jacqueline Trimble
Environmental Assistant
City of Foley

MAYOR: John E. Koniar

CITY ADMINISTRATOR: Michael L. Thompson

CITY CLERK: Vickey Southern

COUNCIL MEMBERS: J. Wayne Trawick; Vera Qualtes; Ralph G. Hellmich; Cecil R. Blackwell; Charles Ebert III

5.26.26

1817 Candlestick CT E

grass/weeds

JAT

