

Use this quote!!

Correct

Quote

11/01/2024



To:
Foley Police Department
Glenn Hartenstein
(251) 424-0529 (Contact)
ghartenstein@foleypolice.org

Project:
Foley Police Dept - Undercounter
Dishwasher

From:
Hannah McNeill
Hawk, Inc.
PO Box 241247
Montgomery, AL 36124
(334) 306-2360
HannahMcNeill@hawkinc.com

Item	Qty	Description	List Each	Discount	Net Each	Net Total
1	1 ea	DISHWASHER, UNDERCOUNTER CMA Dishmachines Model No. L-1X16 W/HEATER Dishwasher, undercounter, 24"W x 23-1/2"D x 34-1/4"H, with sustainer heater, low temperature chemical sanitizing, (30) racks/hour, 16"H dish clearance, built-in chemical pumps & deliming system, built-in primer switches & instant start, upper & lower stainless steel wash arms with reinforced end caps, pumped drain, pump purging system, built-in strainer for water inlet, door safety switch, electrical components housed in stainless steel drawer, stainless steel construction, includes (1) open & (1) peg rack, 1 HP wash pump, NSF, UL, cUL	\$8,980.00	42.5	\$5,163.50	\$5,163.50
		1 ea 115v/60/1-ph, 16.0 amps, standard	\$0.00		\$0.00	\$0.00
Total for item 1						\$5,163.50
Grand Total						\$5,163.50

Delivery to your location included.

Prices are good for purchasing within 30 days and subject to availability.

Before confirming purchase, please verify electrical.
Once you have confirmed acceptance of this quote no item may be canceled, as we will ship it from our inventory or order it specifically for your location.

Payment Terms: NET 30 Days

We appreciate the opportunity to do business with you. We work very hard to please our customers and communication is the key to a successful and enjoyable relationship. Please call us if you have any questions or if we may improve our



service to you.

Hannah Padilla

Statewide Cafeteria and Kitchen Products Contract
MA22000002186

Acceptance: _____ Date: _____

Printed Name: _____

Project Grand Total: \$5,163.50



LOW TEMPERATURE UNDERCOUNTER DISHWASHER / GLASSWASHER

L-1X16

FEATURES



CMA MODEL:L-1X16

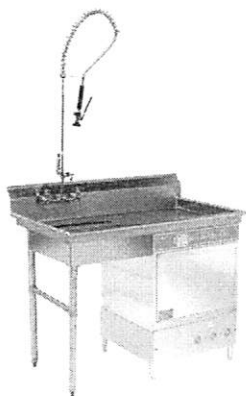

48" Undercounter
dish table with Pre-Rinse

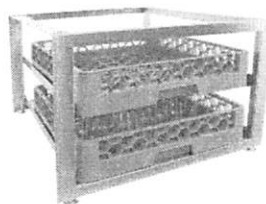

Universal Pedestal



Low Chemical Alarm

- 30 racks / 120 covers per hour.
- Economical to operate. Uses only 1.7 gallons of water per cycle.
- All stainless steel construction assures long life and years of trouble free operation.
- 16" door opening allows the washing of larger items.
- Unique spray arm system features upper and lower stainless steel wash arms with reinforced end caps.
- Built-in chemical pumps and deliming system assures proper chemical usage.
- Convenient to service "Work-in-a-drawer". All electrical components are attached to a sliding drawer for easy access and service.
- Standard pump to draining or uphill stand pipe to drain.
- Pump purging system improves results by eliminating soil and chemical carryover during rinse cycle.
- Stainless steel pump impeller. Offers extended life and service.
- Built-in strainer in water inlet system to prevent water valve from clogging.
- Two dishracks included.
- Built-in primer switches.
- Built-in instant start.
- Door safety switch makes operation safe.
- Built in Sustainer Heater. Maintains incoming water temperature.

AVAILABLE OPTIONS

- The "TEMP-SURE" requires a separate 240v 3 phase 40 amp power supply
- 6" Stainless Steel Legs
- 4" Stainless Steel Legs
- Alternative electrical available for export
- Drain Board

**CMA
MIZER®**
Registered Trademark





L-1X16
Chemical Sanitizing
Undercounter
Dishwasher / Glasswasher

WARNINGS:

- Plumbing connections must be made by a qualified service company who will comply with all available Federal, State, and Local Health, Plumbing and Safety codes.
- CMA recommends utilizing a water softening system to maintain water hardness measurements of 3.5 gpg (grains per gallon) or less. This will assure maximum results and optimum operation of the dishmachine.

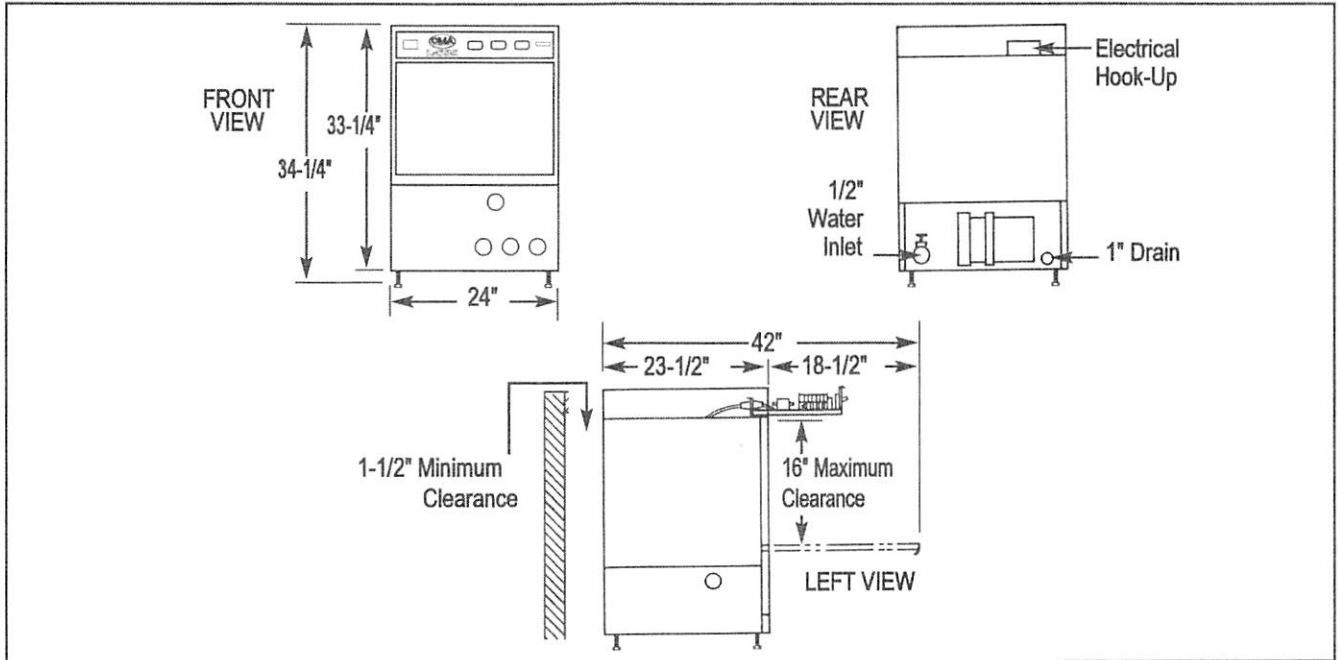

Specifications:

UNDERCOUNTER DISHWASHER	L-1X16	METRIC	USA	METRIC
OPERATING CAPACITY RACKS PER HOUR (NSF RATED)	30	30		
OPERATING CYCLE WASH TIME-SEC	58	58		
RINSE TIME-SEC	32	32		
DWELL/PURGE-SEC	30	30		
TOTAL CYCLE TIME	120	120		
WASH TANK CAPACITY	1.7 GAL.	(6.49 L)		
WASH PUMP CAPACITY	35 GPM	(132.5 LPM)		
OPERATING TEMPERATURE REQUIRED	120°F	(49°C)		
RECOMMENDED	140°F	(60°C)		
WATER CONSUMPTION PER RACK	1.7 GAL.	(6.44 L)		
PER HOUR	51 GAL.	(193 L)		
WATER INLET	1/2"	(1.27 cm)		
DRAIN	1"	(2.54 cm)		
WASH PUMP MOTORS HP			1	1
DIMENSIONS				
DEPTH			23-1/2"	(59cm)
WIDTH			24"	(61cm)
HEIGHT			33-1/4"-34-1/4"	(84-86 cm)
MAXIMUM CLEARANCE HEIGHT FOR WARES			16"	(40.64cm)
STANDARD DISHRACK DIMENSIONS			1 20" x 20"	1 (50.8 x 50.8cm)
ELECTRICAL RATING			VOLTS 115	AMPS 16
APPROXIMATE SHIPPING WEIGHT			175#	(79kg)
SHIPPING DIMENSIONS			PALLET & BOX @ 29" X 28" X 41"	

Summary Specifications: Model L-1X16

CMA Energy Miser model L-1X16 low temperature undercounter chemical sanitizing commercial dishwashers meets NSF, UL and CUL sanitation and construction standards WITHOUT the use of BOOSTER or TANK HEATERS. The model L-1X16 is constructed entirely of stainless steel. Each unit automatically washes, rinses and sanitizes food service utensils in standard 19-3/4"X19-3/4" racks. Units comes standard with upper and lower stainless steel wash arms. The L-1X16 incorporates a pump purging system that improves results by eliminating soil and chemical carryover during rinse cycle.

Advisory: CMA does NOT endorse "Tankless On-Demand" water heaters for use on CMA Dishmachine products. CMA DOES endorse, and highly recommends, the standard "tank" style water heaters, sized properly to handle each particular facility with its water heating requirements.



CMA Dishmachines 12700 Knott Street Garden Grove, CA 92841 • 800-854-6417 • 714-898-8781 • Fax: 714-895-2141 • www.cmadishmachines.com

CMA reserves the right to modify specifications or discontinue models without prior notification.

© 7-2022 CMA, Inc.

an Ai Group Company





Central[®]

RESTAURANT PRODUCTS

11/1/2024 Central Restaurant Products Quote Detail

Quote Number: Q624870
Where OE.QUOTES

Customer # 743050
Phone # 251.943.4431

Quote Date:
 11/1/2024

Ship to address

Bill to address

FOLEY POLICE DEPT
 200 E SECTION AVE

FOLEY POLICE DEPT
 200 E SECTION AVE

*** Expires:**
 11/29/2024

FOLEY
 AL 36535-2703
Attn: GLENN HARTENSTEIN

FOLEY
 AL 36535-2703
Contact: GLENN HARTENSTEIN

Bill Date:

Customer PO#: GLENN HARTENSTEIN
Dest: UNITED STATES
Shp Via: TRUCK
Weight: 148

Rep: 674 MIKE FERRANDO
2dRep: 495 ANDREW KEMP
Collector: MURCHISON, MELISSA
Terms: NEW CUST HOLD

Repl code: N
Rush: N
B/O: P

Comments

Item#	Description	Uom	Qty Ord	Qty BO	Qty Shp	Item Prc	Ext Prc	Est Date
Shipping from our Harrison, OH warehouse								
66377	HOBART CENTERLINE HIGH TEMP UNDRCNTR DIS	EA	1	0	0	5131.000	5131.00	11/01/24
94244	LIFTGATE SERVICE CHARGE	EA	1	0	0	.000	0.00	11/01/24

Total Merchandise: 5,131.00
Additional Chgs: 0.00
Shipping Chgs: 0.00
Tax: 0.00
Total Price: 5,131.00

(US DOLLARS)

CUH HIGH TEMPERATURE Undercounter

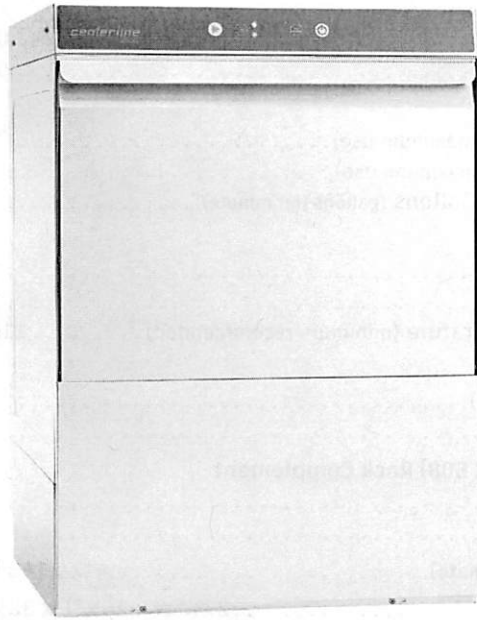

SPECIFIER STATEMENT

Specified unit will be NSF rated, **Centerline by Hobart** high temperature undercounter dishwasher. Features soft start, two selectable cycles, one standard 2-minute cycle with optional extended cycle (factory set at 240 seconds); .84 gallons per rack, LED temperature and operator display, service diagnostics, detergent and rinse aid pumps. Constructed of stainless steel.

1 year parts and labor warranty.

STANDARD VOLTAGE

+ 208-240/60/1

MODELS

- CUH** High temperature rinse

STANDARD FEATURES

- + 24 racks per hour
- + .84 gallons of water per rack
- + Hot water sanitizing
- + Top-mounted user interface with digital temperature display
- + 2-minute cycle with optional extended cycle
- + 14.46" door opening
- + Snap-in, revolving upper and lower anti-clogging wash & rinse arm; low-profile, single-arm design
- + Sense-a-Temp™ ensures 180°F final rinse
- + Integrated booster heater capable of 70°F rise
- + Removable, 3-part stainless steel scrap screen
- + Soft start
- + Automatic pumped drain
- + Automatic fill
- + Service diagnostics with error notifications
- + Delime notification and cycle
- + Chemical pumps standard
- + Electric tank heat
- + Two dishracks – one peg and one combination type

OPTIONS & ACCESSORIES (Available at extra cost)

- Upper/lower stainless steel wash and rinse arm kit
- Chemical sensing indicators (low chemical alert)
- Stainless steel stand with rack storage and telescoping legs (legs in provide 15⁵/₁₆" of additional height; legs out provide 17⁷/₈" of additional height)
- Peg rack
- Combination rack
- Power cord kits
- DWT – Drain water tempering kit

LEGEND

Electrical Connections	
E1	Electrical connection: 1-3/8" dia. hole for 1" trade size conduit; 1-5/8" AFF.
Plumbing Connections	
P1	Single fill and rinse connection: 3/4" female garden hose fitting on 6' long hose supplied with machine; 110°F water minimum for CUH approximately 1-13/16" AFF.
P2	Drain connection: 19mm O.D. barb fitting with 6' long hose supplied with machine.
P3	Chemical supply: Detergent and rinse aid; approximately 1-5/8" AFF. 63" long, 6mm O.D. tubing supplied with machine.

WARNING: Electrical and grounding connections must comply with the applicable portion of the National Electrical Code and/or other local electrical codes.

Plumbing connections must comply with applicable sanitary, safety, and plumbing codes.

(E1) STANDARD ELECTRICAL OPTIONS

Voltage	Rated Amps	Minimum Supply Circuit Ampacity	Maximum Protective Device
208/60/1	24.2	30	30
240/60/1	27.5	30	30

NOTE: For supply connections, use copper wire only rated at 90°C minimum.

Accessory cord kit available for all models.

Dishmachine not provided with internal GFCI protection.

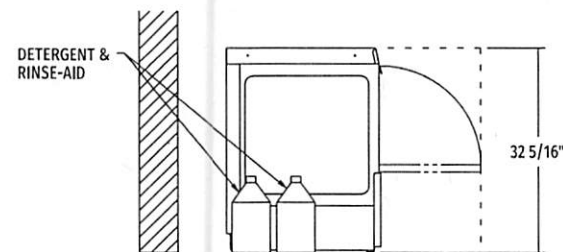

Left Side View

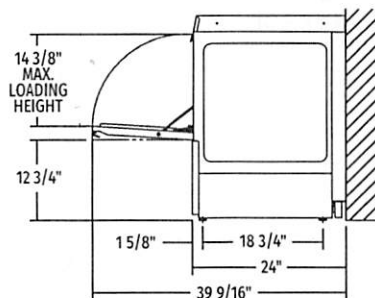

Right Side View

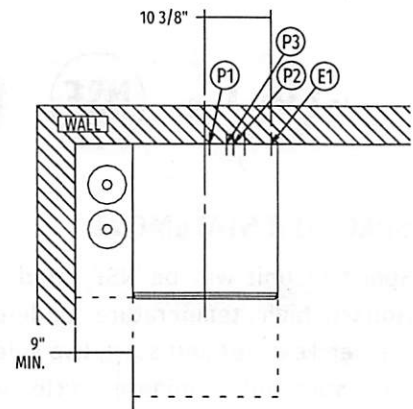

Top View

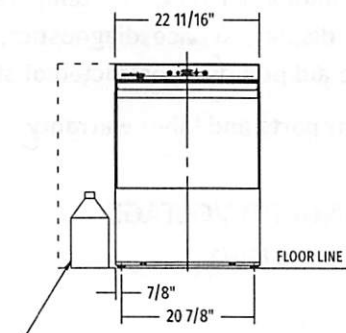

Front View

SPECIFICATIONS

Capacities

Cycle Time (seconds)	120
Racks per Hour	24
Tank Capacity – Gallons	5.3

Motor Horsepower

Wash	0.62
Rinse	0.20

Water Consumption

U.S. Gallons per Hour (maximum use)	20.2
U.S. Gallons per Rack (maximum use)	0.84
Peak Drain Flow – U.S. Gallons (gallons per minute)	2.8

Temperatures °F

Wash	150
Rinse	180
Incoming Water Temperature (minimum recommended)	110°F

Heating

Tank Heat, electric (kW)	5.5
Electric Booster (kW)	6.0

Standard 20" x 20" (508 x 508) Rack Complement

Flat	1
Peg	1

Shipping Weight (approximate) 148 lbs.

Crated Dimensions 27 1/4"W x 26 1/2"L x 38 3/4"H

Heat Output, BTU/Hour		
Volts	Latent	Sensible
208	4,300	1,800
240	5,600	2,400

MODEL:
CUH
00-562543
REV E

Sales Quote

Sales Quote Number: 678648

Page: 1

**KaTom Restaurant Supply, Inc.
305 Katom Dr.
KODAK, TN 37764**

Sales Quote Date: 11/1/2024	Due Date 11/1/2024	Ship Date 11/1/2024
Customer ID 1757741	Contact Glenn Hartenstein	SalesPerson Tyler Parker
Cust. Phone (251) 952-4010	Cust. Fax	Quote Expires:
ghartenstein@foleypolice.org		

Sell
To: Foley Police Department
 Glenn Hartenstein
 200 E Section Ave
 FOLEY, AL 36535
 USA

Ship
To: Foley Police Department
 Glenn Hartenstein
 200 E Section Ave
 FOLEY, AL 36535
 USA

Terms CREDIT CARD	Ext Doc No.	Your Reference	Ship Via	Loc Code KODAK	Loc Phone	Loc Fax
----------------------	-------------	----------------	----------	-------------------	-----------	---------

<u>Blueprint No.</u>	<u>Number</u>	<u>Description</u>	<u>Quantity</u>	<u>Unit</u>	<u>Unit Price</u>	<u>Total Price</u>
	617-EUH1	ECOLINE UC DISHWASHER HIGH-TEMP 208/1 Free Shipping to Customer Must Ship LTL Quote for Glenn Hartenstein Quote good for 5 days Ships LTL, Liftgate Required	1	EA	4,479.00	4,479.00

Website: katom.com **Phone:** (800) 541-8683 **Fax:** (800) 821-9130

This office will follow up with you within 24 hours to ensure you received this quotation. Quotation must be signed below to be official.

Submitted by: _____ **Accepted by:** _____

Subtotal: 4479.00
 S, H, & I: 45.00
 Total Sales Tax: 358.32
 Total: 4882.32

Federal and/or State tax laws may apply at the time of invoicing.

BY PLACING YOUR ORDER, YOU ACKNOWLEDGE AND AGREE THAT YOU HAVE READ AND AGREE TO BE BOUND BY KATOM'S POLICIES AND PROCEDURES STANDARD TERMS AND CONDITIONS, POLICIES AND PROCEDURES, INCLUDING BUT NOT LIMITED TO THE KATOM PRIVACY POLICY, RETURN POLICY, SHIPPING POLICY, AND TERMS AND CONDITIONS (WHICH INCLUDE DISCLAIMERS AND LIMITATIONS OF KATOM'S LIABILITY, AS WELL AS A PROVISION WHEREBY YOU AGREE TO ARBITRATE ALL DISPUTES), LOCATED AT WWW.KATOM.COM/POLICY (COLLECTIVELY, THE "TERMS"). PLEASE CALL 1-800-541-8683 TO OBTAIN A PHYSICAL OR E-MAIL COPY OF THE TERMS. THE TERMS ARE ALSO AVAILABLE BY SCANNING THE QR CODE IN THE BOTTOM RIGHTHAND CORNER OF THIS QUOTE WITH THE CAMERA OF YOUR MOBILE DEVICE. IF YOU DO NOT AGREE TO BE BOUND BY ALL PROVISIONS OF THE TERMS, YOU MUST NOTIFY KATOM WITHIN TEN (10) DAYS OF RECEIPT OF THIS QUOTE AND IMMEDIATELY REJECT AND RETURN ALL GOODS TO KATOM. YOUR USE OF THE GOODS, OR YOUR FAILURE TO REJECT AND RETURN THE GOODS TO KATOM WITHIN TEN (10) DAYS, SHALL CONSTITUTE ACCEPTANCE OF ALL TERMS.

